



T. Harris Environmental Management Inc.  
*Environmental Consultants*

931 Commissioners Rd East,  
Suite 100  
London, Ontario N5Z 3H9  
Tel. (519) 685-9048  
Fax. (519) 685-1084  
**1-888-ASK-THEM**

---

**ASBESTOS REASSESSMENT SURVEY  
VICTORIA PUBLIC SCHOOL  
135 GIBBONS STREET  
GODERICH, ONTARIO**

**Issued: June 22<sup>nd</sup>, 2011  
Updated: August 25<sup>th</sup>, 2011**

Prepared for:

**Mr. Mike Rau**  
Avon Maitland District School Board  
62 Chalk Street North  
Seaforth, Ontario  
N0K 1W0

Prepared by:

**T. Harris Environmental Management Inc.**  
931 Commissioners Road East, Suite  
London, Ontario  
N5Z 3H9

**THEM Project # 11-01707-48**



T. Harris Environmental Management Inc.  
*Environmental Consultants*

931 Commissioners Rd East,  
Suite 100  
London, Ontario N5Z 3H9  
Tel. (519) 685-9048  
Fax. (519) 685-1084  
**1-888-ASK-THEM**

---

## CONTENTS

<b>EXECUTIVE SUMMARY .....</b>	<b>i</b>
<b>1.0 INTRODUCTION.....</b>	<b>1</b>
<b>2.0 BACKGROUND .....</b>	<b>2</b>
<b>3.0 ONTARIO REGULATIONS FOR ASBESTOS IN BUILDING MATERIALS.....</b>	<b>2</b>
<b>4.0 METHODOLOGY .....</b>	<b>2</b>
<b>5.0 ASSESSMENT OF ASBESTOS-CONTAINING MATERIALS.....</b>	<b>3</b>
<b>6.0 FINDINGS.....</b>	<b>3</b>
6.1 TEXTURE FINISHES .....	7
6.2 MECHANICAL INSULATION .....	8
6.2.1 LINEAR PIPE INSULATION .....	8
6.2.2 PIPE FITTING INSULATION .....	8
6.3 CEILING TILES .....	8
6.4 VINYL FLOOR TILES .....	9
6.5 VINYL SHEET FLOORING .....	10
6.6 CAULKING .....	10
6.7 OTHER .....	10
<b>7.0 CONCLUSIONS AND RECOMMENDATIONS.....</b>	<b>11</b>
<b>8.0 LIMITATIONS.....</b>	<b>16</b>
<b>Appendix I – Site Photographs</b>	
<b>Appendix II – Floor Plans</b>	
<b>Appendix III – Laboratory Certificates of Analysis</b>	
<b>Appendix IV – Room by Room Sheets</b>	



## EXECUTIVE SUMMARY

T. Harris Environmental Management Inc. was retained by the Avon Maitland District School Board to conduct an Asbestos Reassessment Survey, based on THEM's "Hazardous Materials Building Survey" dated June 2005 and "Asbestos Reassessment Survey" reports dated July 2006, July 2007, October 2008, September 2009 and November 2010 for Victoria Public School located at 135 Gibbons Street, Goderich, Ontario. The reassessment was conducted on June 6<sup>th</sup>, 2011 and updated August 22<sup>nd</sup>, 2011 following the repair of all materials identified on June 6<sup>th</sup>, 2011 as a Priority 1 condition as defined below.

The objective of this study is to determine the condition of building materials known to contain asbestos, a Designated Substance as defined under the Ontario Occupational Health and Safety Act. The survey included a review of all accessible areas for the condition of known asbestos-containing materials (ACM). It should be noted that ceiling spaces within the building may have been inaccessible due to height restrictions, thus asbestos-containing materials should be suspected to be present in these areas until proven otherwise. Asbestos materials re-assessed were assigned a Priority rating. Any materials assigned a Priority 1 are highly recommended to be removed, repaired or encapsulated. Materials identified as Priority 2 may remain in place until system upgrading, renovations or activities that may disturb ACM and, materials assigned a Priority 3 may remain in place until the building is demolished.

Based on the investigation conducted by T. Harris Environmental Management, the following Table summarizes the findings of the reassessment of all the asbestos-containing materials. Materials which have been removed are italicized.

**TABLE 1**  
**Summary of Re-Assessment of Asbestos-Containing Materials**  
**Victoria Public School**  
**Goderich, Ontario**  
**August 22<sup>nd</sup>, 2011**

Location Description	Material	Quantity	Priority	Type(s) of Asbestos	Friable (Y/N)	Photograph
Room 1.10 – Office	2' x 4' Ceiling Tile	518 ft <sup>2</sup>	2	Chrysotile	N/A	--
Room 1.11 – Health Room	2' x 4' Ceiling Tile	208 ft <sup>2</sup>	2	Chrysotile	N/A	--
Room 1.12 – Staff Room	2' x 4' Ceiling Tile	336 ft <sup>2</sup>	2	Chrysotile	N/A	--
Room 1.13 – Vice Principal	2' x 4' Ceiling Tile	138 ft <sup>2</sup>	2	Chrysotile	N/A	--
Room 1.15 – Early Years	2' x 4' Ceiling Tile	1046 ft <sup>2</sup>	2	Chrysotile	N/A	--
Room 1.17 – Vestibule	2' x 4' Ceiling Tile	296 ft <sup>2</sup>	2	Chrysotile	N/A	--



T. Harris Environmental Management Inc.  
*Environmental Consultants*

931 Commissioners Rd East,  
 Suite 100  
 London, Ontario N5Z 3H9  
 Tel. (519) 685-9048  
 Fax. (519) 685-1084  
**1-888-ASK-THEM**

Location Description	Material	Quantity	Priority	Type(s) of Asbestos	Friable (Y/N)	Photograph
Room 1.18 – Storage	2' x 4' Ceiling Tile	78 ft <sup>2</sup>	2	Chrysotile	N/A	--
Room 1.19 – Office	2' x 4' Ceiling Tile	96 ft <sup>2</sup>	2	Chrysotile	N/A	--
Room 1.20 – C.L.N.	2' x 4' Ceiling Tile	N/A**	2	Chrysotile	N/A	--
Room 1.23 - Classroom	2' x 4' Ceiling Tile	783 ft <sup>2</sup>	2	Chrysotile	N/A	--
Room 1.31 – Girls Washroom	2' x 4' Ceiling Tile	241 ft <sup>2</sup>	2	Chrysotile	N/A	--
Room 1.33 – Storage	2' x 4' Ceiling Tile	204 ft <sup>2</sup>	2	Chrysotile	N/A	--
Room 1.34 – C.L.N.	2' x 4' Ceiling Tile	1192 ft <sup>2</sup>	2	Chrysotile	N/A	--
Room 1.38 – Girls Change Room	2' x 4' Ceiling Tile	548 ft <sup>2</sup>	2	Chrysotile	N/A	--
Room 1.44 – Boys Change Room	2' x 4' Ceiling Tile	N/A**	2	Chrysotile	N/A	--
Room 1.48 – Classroom	2' x 4' Ceiling Tile	N/A**	2	Chrysotile	N/A	--
Room 2.13 – Library	2' x 4' Ceiling Tile	N/A**	2	Chrysotile	N/A	--
Room 2.14 – Workroom	2' x 4' Ceiling Tile	208 ft <sup>2</sup>	2	Chrysotile	N/A	--
Room 2.15 – Computer Area	2' x 4' Ceiling Tile	N/A**	2	Chrysotile	N/A	--
Room 2.16 – Special Education Resource	2' x 4' Ceiling Tile	N/A**	2	Chrysotile	N/A	--
Room 2.17 – Guidance	2' x 4' Ceiling Tile	333 ft <sup>2</sup>	2	Chrysotile	N/A	--
Corridor 1.C01	2' x 4' Ceiling Tile	N/A**	2	Chrysotile	N/A	--
Corridor 1.C02	2' x 4' Ceiling Tile	N/A**	2	Chrysotile	N/A	--
Corridor 1.C03	2' x 4' Ceiling Tile	N/A**	2	Chrysotile	N/A	--
Corridor 1.C04	2' x 4' Ceiling Tile	N/A**	2	Chrysotile	N/A	--
Corridor 1.C05	2' x 4' Ceiling Tile	N/A**	2	Chrysotile	N/A	--
Corridor 1.C06	2' x 4' Ceiling Tile	N/A**	2	Chrysotile	N/A	--
Corridor 1.C07	2' x 4' Ceiling Tile	N/A**	2	Chrysotile	N/A	--
Room 1.01 – Classroom	Texture Finish	766 ft <sup>2</sup>	2	Chrysotile	Yes	--
Room 1.02 – Classroom	Texture Finish	763 ft <sup>2</sup>	2	Chrysotile	Yes	--



T. Harris Environmental Management Inc.  
Environmental Consultants

931 Commissioners Rd East,  
Suite 100  
London, Ontario N5Z 3H9  
Tel. (519) 685-9048  
Fax. (519) 685-1084  
**1-888-ASK-THEM**

Location Description	Material	Quantity	Priority	Type(s) of Asbestos	Friable (Y/N)	Photograph
Room 1.03 - Vestibule	Texture Finish	276 ft <sup>2</sup>	2	Chrysotile	Yes	--
Room 1.04 - Classroom	Texture Finish	757 ft <sup>2</sup>	2	Chrysotile	Yes	--
Room 1.01 - Classroom	Texture Finish	765 ft <sup>2</sup>	2	Chrysotile	Yes	--
Room 1.05 - Classroom	Texture Finish	765 ft <sup>2</sup>	2	Chrysotile	Yes	--
Room 1.06 - Classroom	Texture Finish	764 ft <sup>2</sup>	2	Chrysotile	Yes	--
Room 1.08 - Vestibule	Texture Finish	502 ft <sup>2</sup>	2	Chrysotile	Yes	--
Room 1.09 - Classroom	Texture Finish	849 ft <sup>2</sup>	2	Chrysotile	Yes	--
Room 1.30 - Gym	Texture Finish	2819 ft <sup>2</sup>	2	Chrysotile	Yes	--
Room 1.51 - Workroom	Texture Finish	~ 100 ft <sup>2</sup>	2	Chrysotile	Yes	--
2 <sup>nd</sup> Floor Corridor	Texture Finish	--	2	Chrysotile	Yes	--
Room 2.03 - Classroom	Texture Finish	878 ft <sup>2</sup>	2	Chrysotile	Yes	--
Room 2.05 - Classroom	Texture Finish	873 ft <sup>2</sup>	2	Chrysotile	Yes	--
Room 2.06 - Vestibule	Texture Finish	281 ft <sup>2</sup>	2	Chrysotile	Yes	--
Room 2.07 - Classroom	Texture Finish	869 ft <sup>2</sup>	2	Chrysotile	Yes	--
Room 2.08 - Classroom	Texture Finish	872 ft <sup>2</sup>	2	Chrysotile	Yes	--
Room 2.09 - Classroom	Texture Finish	871 ft <sup>2</sup>	2	Chrysotile	Yes	--
Room 2.12 - Classroom	Texture Finish	901 ft <sup>2</sup>	2	Chrysotile	Yes	--
Room 1.31 - Girls Washroom	Linear Pipe Insulation	~ 20 ft.	2	Chrysotile	Yes	1
Corridor 1.C02	Linear Pipe Insulation	REMOVED 2011	2	Chrysotile	Yes	2
Corridor 1.C05	Pipe Fitting	23	2	Chrysotile	Yes	3
Corridor 1.C06	Pipe Fitting	10	2	Chrysotile	Yes	--
Room 1.31 - Girls Washroom	Pipe Fitting	12	2	Chrysotile	Yes	4
Room 1.33 - Storage (below ceiling)	Pipe Fitting	REMOVED 2007/08	--	--	--	--
Room 1.33 - Storage (above ceiling)	Pipe Fitting	REMOVED 2008/09	--	--	--	--
Room 1.39 - Custodian	Pipe Fitting	7	2	Chrysotile	Yes	--



T. Harris Environmental Management Inc.  
Environmental Consultants

931 Commissioners Rd East,  
Suite 100  
London, Ontario N5Z 3H9  
Tel. (519) 685-9048  
Fax. (519) 685-1084  
1-888-ASK-THEM

Location Description	Material	Quantity	Priority	Type(s) of Asbestos	Friable (Y/N)	Photograph
Room 1.42 – Electrical Room	Pipe Fitting	4	2	Chrysotile	Yes	--
Room 1.43 – Boiler Room	Pipe Fitting	30	2	Chrysotile	Yes	--
Room 1.38 – Girls Change Room	*Transite Pipe	8 ft.	2	--	No	--
Room 1.11 – Health Room (Washroom)	Light Fixture Heat Shield	REMOVED 2008/09	--	--	--	--
Room 1.15 – Early Years (Washroom)	Light Fixture Heat Shield	REMOVED 2008/09	--	--	--	--
Room 2.03 – Classroom	*9" x 9" Vinyl Floor Tiles	878 ft <sup>2</sup>	2	--	No	--
Room 2.04 – Workroom	*9" x 9" Vinyl Floor Tiles	242 ft <sup>2</sup>	2	--	No	--
Room 2.07 – Classroom	*9" x 9" Vinyl Floor Tiles	869 ft <sup>2</sup>	2	--	No	--
Room 2.08 – Classroom	9" x 9" Vinyl Floor Tiles	872 ft <sup>2</sup>	2	Chrysotile	No	--
Room 2.09 – Classroom	9" x 9" Vinyl Floor Tiles	871 ft <sup>2</sup>	2	Chrysotile	No	--
Room 2.12 – Classroom	9" x 9" Vinyl Floor Tiles	901 ft <sup>2</sup>	2	Chrysotile	No	--
Room 1.01 – Classroom	*1' x 1' Vinyl Floor Tiles	766 ft <sup>2</sup>	2	--	No	--
Room 1.02 – Classroom	*1' x 1' Vinyl Floor Tiles	763 ft <sup>2</sup>	2	--	No	--
Room 1.04 – Classroom	*1' x 1' Vinyl Floor Tiles	757 ft <sup>2</sup>	2	--	No	--
Room 1.05 – Classroom	*1' x 1' Vinyl Floor Tiles	765 ft <sup>2</sup>	2	--	No	--
Room 1.06 – Classroom	*1' x 1' Vinyl Floor Tiles	764 ft <sup>2</sup>	2	--	No	--
Room 1.09 – Classroom	*1' x 1' Vinyl Floor Tiles	849 ft <sup>2</sup>	2	--	No	5
Room 1.10 – Office Workroom	*1' x 1' Vinyl Floor Tiles	--	2	--	No	--
Room 1.11 – Health Room	*1' x 1' Vinyl Floor Tiles	208 ft <sup>2</sup>	2	--	No	--
Room 1.15 – Classroom	*1' x 1' Vinyl Floor Tiles	~ 500 ft <sup>2</sup>	2	--	No	--
Room 1.18 – C.L.N. Storage	*1' x 1' Vinyl Floor Tiles	78 ft <sup>2</sup>	2	--	No	--
Room 1.19 – C.L.N. Office	*1' x 1' Vinyl Floor Tiles	96 ft <sup>2</sup>	2	--	No	--
Room 1.20 – C.L.N.	*1' x 1' Vinyl Floor Tiles	838 ft <sup>2</sup>	2	--	No	--
Room 1.21 – Early Years	*1' x 1' Vinyl Floor Tiles	~ 350 ft <sup>2</sup>	2	--	No	--



Location Description	Material	Quantity	Priority	Type(s) of Asbestos	Friable (Y/N)	Photograph
Room 1.23 – Classroom	*1' x 1' Vinyl Floor Tiles	783 ft <sup>2</sup>	2	--	No	--
Room 1.24 – Boys' Washroom	*1' x 1' Vinyl Floor Tiles	92 ft <sup>2</sup>	2	--	No	--
Room 1.25 – Classroom	*1' x 1' Vinyl Floor Tiles	805 ft <sup>2</sup>	2	--	No	--
Room 1.33 – Storage	*1' x 1' Vinyl Floor Tiles	204 ft <sup>2</sup>	2	--	No	--
Room 1.34 – C.L.N	*1' x 1' Vinyl Floor Tiles	~ 500 ft <sup>2</sup>	2	--	No	--
Room 1.48 – Classroom	*1' x 1' Vinyl Floor Tiles	898 ft <sup>2</sup>	2	--	No	--
Room 1.51 – Workroom	*1' x 1' Vinyl Floor Tiles	~ 100 ft <sup>2</sup>	2	--	No	--
Corridor 1.C04	*1' x 1' Vinyl Floor Tiles	--	2	--	No	--
Room 2.05 – Classroom	*1' x 1' Vinyl Floor Tiles	873 ft <sup>2</sup>	2	--	No	--
Room 2.15 – Computer Area	*1' x 1' Vinyl Floor Tiles	--	2	--	No	--
Room 2.16 – Special Education Resource	*1' x 1' Vinyl Floor Tiles	--	2	--	No	--
Corridor 2.C01	*1' x 1' Vinyl Floor Tiles	--	2	--	No	--

\*- Materials assumed to contain asbestos until proven otherwise

\*\* - Asbestos-containing acoustic ceiling tiles can not be quantified due to several types of tile being present

Based on the findings of this report THEM recommends the following:

- Friable asbestos-containing materials assigned a Priority 1 (if applicable) must be removed and/or repaired immediately following applicable asbestos abatement procedures. Friable asbestos-containing materials assigned a Priority 2 can remain in place until major system upgrading, maintenance or demolition which could result in disturbance of this material. In the event the friable asbestos-containing materials are removed, Type III asbestos abatement procedures apply as outlined in Ontario Regulation 278/05, Regulation respecting Asbestos on Construction Projects and in Buildings and Repair Operations – made under the Ontario Occupational Health and Safety Act. Type II asbestos abatement procedures can be applied for the repair of damaged mechanical pipe insulation or, the removal of less than 1 square metre of friable asbestos-containing materials. In addition, Type II Glovebag asbestos abatement procedures can be applied for the removal of asbestos-containing mechanical pipe insulation fittings as outlined in Ontario Regulation 278/05.
- Non-friable asbestos-containing materials assigned a Priority 2 can remain in place until major system upgrading, maintenance or demolition which could result in disturbance of this material. In the event the non-friable asbestos-containing materials are removed, Type I



asbestos abatement procedures apply (provided that the material is wetted down and removed using non-powered hand held tools) as outlined in Ontario Regulation 278/05, Regulation respecting Asbestos on Construction Projects and in Buildings and Repair Operations – made under the Ontario Occupational Health and Safety Act.

- Asbestos-containing suspended ceiling tiles assigned a Priority 2, can remain in place until major system upgrading, maintenance or demolition which could result in disturbance of this material. In the event the asbestos-containing ceiling tiles are removed, Type I operations apply for the removal of <7.5 square metres of suspended ceiling tiles, otherwise removal of >7.5 square metres of suspended ceiling tiles must be conducted following Type II operations as outlined in Ontario Regulation 278/05, Regulation respecting Asbestos on Construction Projects and in Buildings and Repair Operations – made under the Ontario Occupational Health and Safety Act
- Respiratory protection equipment worn by contractors conducting abatement activities should be selected based on Table 2 Respirators found in Ontario Regulation 278/05
- In the event all asbestos material within the building is not removed, an asbestos management program must be implemented according to Ontario Regulation 278/05.
- Vinyl floors tiles were analysed using the PLM method of detection as required by Ontario Regulation 278/05. However, given the composition of vinyl floor products, the PLM analysis method is often prone to yielding false negative analysis results. Therefore it may be prudent that the Transmission Electron Microscopy (TEM) analysis method be used to determine the asbestos content in the vinyl floor tiles.

All asbestos repair or removal must be conducted according to Ontario Regulation 278/05, Regulation respecting Asbestos on Construction Projects and in Buildings and Repair Operations - made under the Occupational Health and Safety Act. Asbestos-containing waste has to be handled and disposed of according to Ontario Regulation 347/90 as amended – made under the Environmental Protection Act.

This survey satisfies requirements of Ontario Regulation 278/05, Regulation respecting Asbestos on Construction Projects and in Buildings and Repair Operations. This executive summary is not to be used alone and the report should be reviewed in its entirety.

Should you have any questions or comments regarding this survey, please do not hesitate to contact our office.

Sincerely,

**T. HARRIS ENVIRONMENTAL MANAGEMENT INC.**





T. Harris Environmental Management Inc.  
*Environmental Consultants*

931 Commissioners Rd East,  
Suite 100  
London, Ontario N5Z 3H9  
Tel. (519) 685-9048  
Fax. (519) 685-1084  
**1-888-ASK-THEM**

---

August 25<sup>th</sup>, 2011

Avon Maitland District School Board  
62 Chalk Street North  
Seaforth, Ontario  
N0K 1W0

**ATTN: Mr. Mike Rau**  
Administrator of Facilities

**RE: Asbestos Reassessment Survey - Victoria Public School**  
135 Gibbons Street, Goderich, Ontario

---

## 1.0 INTRODUCTION

T. Harris Environmental Management Inc. (THEM) was retained by the Avon Maitland District School Board (AMDSB) to conduct an Asbestos Reassessment Survey, based on THEM's "*Hazardous Materials Building Survey*" dated June 2005 and "*Asbestos Reassessment Survey*" reports dated July 2006, July 2007, October 2008, September 2009 and November 2010 for Victoria Public School located at 135 Gibbons Street, Goderich, Ontario. The reassessment was conducted on June 6<sup>th</sup>, 2011 and updated August 22<sup>nd</sup>, 2011 following the repair of all materials identified on June 6<sup>th</sup>, 2011 as a Priority 1 condition as defined below.

The objective of this study is to determine the condition of building materials known to contain asbestos, a Designated Substance as defined under the Ontario Occupational Health and Safety Act. The survey included a review of all accessible areas for the condition of known asbestos-containing materials (ACM). It should be noted that ceiling spaces within the building may have been inaccessible due to height restrictions, thus asbestos-containing materials should be suspected to be present in these areas until proven otherwise.

According to drawings supplied by AMDSB, this school was constructed in 1948, with additions constructed in 1974 and renovations conducted in 1994. The building consists of two floors, and is approximately 44,580 square feet.



## 2.0 BACKGROUND

Asbestos is a general name for several varieties of highly fibrous silicate minerals. Commercially significant types include *Chrysotile*, *Amosite* and *Crocidolite*. The fibres are valued for their heat- and chemical-resistant properties. The combination of fibrous structures, low heat conductivity, high electrical resistance, chemical inertness, strength, flexibility and its effectiveness as a reinforcing or binding agent when combined with cement or plastic, made it popular for wide industrial use.

Products with bound asbestos pose no danger of releasing airborne fibres unless cut, sawn, ground or sanded. One measure of the potential hazard of a product is its friability. The friability of an asbestos-containing material is a measure of the ease with which the material can be ground or pulverized. Knowledge of the friability of an ACM may theoretically measure the ease with which fibres can be released into the air.

This report briefly explains the survey methodology and summarizes its findings. This survey satisfies requirements of Ontario Regulation 278/05 - Regulation respecting Asbestos on Construction Projects and in Buildings and Repair Operations.

## 3.0 ONTARIO REGULATIONS FOR ASBESTOS IN BUILDING MATERIALS

Asbestos is a Designated Substance and, as such, exposure to airborne asbestos is regulated by Ontario Regulation 278/05 – *Asbestos on Construction Projects and in Buildings and Repair Operations* and, Ontario Regulation 279/05 – *Designated Substance – Asbestos* – both made under the Occupational Health and Safety Act.

Waste management of materials that contain asbestos is regulated by Ontario Regulation 347/90 as amended, made under the Environmental Protection Act. Section 17 of this regulation outlines the requirements for proper handling, transportation and disposal of materials that contain asbestos.

## 4.0 METHODOLOGY

The re-assessment survey was a visual inspection to assess the condition of the asbestos-containing materials previously identified in the THEM reports “*Hazardous Materials Building Survey*” and “*Asbestos Reassessment Survey*” dated June 2005, July 2006, July 2007, October 2008, September 2009 and November 2010 respectively, for Victoria Public School. No destructive testing was performed. Inaccessible spaces within the building were not inspected. It should be noted that ceiling spaces within the building may have been inaccessible due to height restrictions, thus asbestos-containing materials should be suspected to be present in these areas until proven otherwise. Any building materials observed that were not previously sampled in past surveys, were sampled according to the sampling requirements found in Table 1 of Ontario Regulation 278/05.



This investigation was conducted in accordance with Ontario Regulation 278/05, *Regulation respecting Asbestos on Construction Projects and in Buildings and Repair Operations*.

It should be noted that the following materials were not sampled (if present on site) as destructive sampling would be required to access them: internal components of boilers, fire doors, elevator brakes, caulking, roofing felts and mastics, high voltage wiring, mechanical packing and gaskets, and underground services or piping. All of these materials should be considered to contain asbestos until proven otherwise.

## **5.0 ASSESSMENT OF ASBESTOS-CONTAINING MATERIALS**

Priorities for remedial action have been assigned to individual items, or defined areas, based primarily on condition of the asbestos-containing materials. Priorities have been established for remedial action based on these parameters, and are given below.

### **Priority 1 (One)**

- Asbestos-containing material highly recommended to be removed, repaired or encapsulated.

### **Priority 2 (Two)**

- Asbestos-containing materials could remain in place until system upgrading, renovations or activities that may disturb the ACM.

### **Priority 3 (Three)**

- Asbestos-containing material could remain in place until eventual building demolition.

## **6.0 FINDINGS**

Laboratory Certificates of Analysis detailing results of bulk samples collected during the 2004 and 2006 assessments are attached in Appendix II of the 2006 “*Asbestos Reassessment Survey*” with results summarized in Table 2 and Table 3, below. Sampling results of additional samples collected during the 2011 survey are summarized in Table 4 below with Laboratory Certificates of Analysis presented in Appendix III. Samples found to be asbestos-containing are bolded and shaded.



**TABLE 2**  
**Summary of Asbestos Bulk Samples**  
**Victoria Public School**  
**December 6<sup>th</sup>, 2004**

Sample #	Location	Description	Asbestos Content
1 (SACM 7)	Room 1.11 – Health Room Washroom	White insulation (Heat Shield)	99% <i>Chrysotile</i>
2 (SACM 8)	Room 2.10 – Upper Fan Room	Flex Connector	None Detected
3 (SACM 9)	Room 2.12 - Classroom	Red, 9' x 9' Vinyl Floor Tile	6.5% <i>Chrysotile</i>

**TABLE 3**  
**Summary of Asbestos Bulk Samples**  
**Victoria Public School**  
**May 4<sup>th</sup>, 2006**

Sample #	Location	Description	Asbestos Content
1A	Room 1.43 – Boiler Room	Pipe Fitting Insulation	40% <i>Chrysotile</i>
1B	Room 1.43 – Boiler Room	Pipe Fitting Insulation	ANR
1C	Room 1.43 – Boiler Room	Pipe Fitting Insulation	ANR
2A	Corridor near Room 1.38	2' x 4' Ceiling Tile	ND
2B	Corridor near Room 1.38	2' x 4' Ceiling Tile	ND
2C	Corridor near Room 1.38	2' x 4' Ceiling Tile	10% <i>Chrysotile</i>
3A	1974 Portion, Corridor	Plaster	None Detected
3B	1974 Portion, Corridor	Plaster	None Detected
3C	1974 Portion, Corridor	Plaster	None Detected
3D	1974 Portion, Corridor	Plaster	None Detected
3E	1974 Portion, Corridor	Plaster	None Detected
3F	1974 Portion, Corridor	Plaster	None Detected
3G	1974 Portion, Corridor	Plaster	None Detected
4A	Room 1.09	Texture Finish on ceiling	<0.25% <i>Chrysotile</i>
4B	Room 1.09	Texture Finish on ceiling	<0.25% <i>Chrysotile</i>
4C	Stairway 1.08	Texture Finish on ceiling	3% <i>Chrysotile</i>



Sample #	Location	Description	Asbestos Content
4D	Stairway 1.08	Texture Finish on ceiling	ANR
4E	Corridor near Room 2.10	Texture Finish on ceiling	ANR
4F	Corridor near Room 2.10	Texture Finish on ceiling	ANR
4G	Corridor near Room 2.01	Texture Finish on ceiling	ANR
5A	Room 1.09	Plaster	None Detected
5B	Room 1.09	Plaster	None Detected
5C	Northwest Entrance	Plaster	None Detected
5D	Northwest Entrance	Plaster	None Detected
5E	Corridor near Room 2.10	Plaster	None Detected
5F	Corridor near Room 2.10	Plaster	None Detected
5G	Corridor near Room 2.10	Plaster	None Detected

ANR – Analysis Not Required – Material Known to Be Asbestos-Containing

**TABLE 4**  
**Summary of Asbestos Bulk Samples**  
**Victoria Public School**  
**June 6<sup>th</sup>, 2011**

Sample #	Location	Description	Asbestos Content
AirCell-01	Corridor 1.C02	Aircell pipe insulation	45% Chrysotile
AirCell-02	Corridor 1.C02	Aircell pipe insulation	ANR
AirCell-03	Corridor 1.C02	Aircell pipe insulation	ANR
ACT-A-01	Library – Room 2.13	2' x 4' Ceiling Tile with “small length horizontal fissures, small pinholes and small dents” pattern	PC 2.8% Chrysotile
ACT-A-02	Library – Room 2.13	2' x 4' Ceiling Tile with “small length horizontal fissures, small pinholes and small dents” pattern	ANR
ACT-A-03	Computer Area – Room 2.15	2' x 4' Ceiling Tile with “small length horizontal fissures, small pinholes and small dents” pattern	ANR



Sample #	Location	Description	Asbestos Content
ACT-B-01	Library – Room 2.13	2' x 4' Ceiling Tile with “medium length horizontal fissures and small/medium pinholes” pattern. A dotted pattern reading <<< 7 12 6 <<< is present on the back of the tiles	None Detected
ACT-B-02	Library – Room 2.13	2' x 4' Ceiling Tile with “medium length horizontal fissures and small/medium pinholes” pattern. A dotted pattern reading <<< 7 12 6 <<< is present on the back of the tiles	None Detected
ACT-B-03	Janitors Room – Room 2.10	2' x 4' Ceiling Tile with “medium length horizontal fissures and small/medium pinholes” pattern. A dotted pattern reading <<< 7 12 6 <<< is present on the back of the tiles	None Detected
ACT-C-01	Library – Room 2.13	2' x 4' Ceiling Tile with “small ‘y’ shaped fissures and small pinholes” pattern	None Detected
ACT-C-02	Library – Room 2.13	2' x 4' Ceiling Tile with “small ‘y’ shaped fissures and small pinholes” pattern	None Detected
ACT-C-03	Boys Washroom – Room 1.32	2' x 4' Ceiling Tile with “small ‘y’ shaped fissures and small pinholes” pattern	None Detected
ACT-D-01	Corridor 1.C02	<b>2' x 4' Ceiling Tile with “small length horizontal fissures and sparse small pinholes” pattern</b>	<b>None Detected</b>
ACT-D-02	Corridor 1.C02	<b>2' x 4' Ceiling Tile with “small length horizontal fissures and sparse small pinholes” pattern</b>	<b>None Detected</b>
ACT-D-03	Girls Washroom – Room 1.31	<b>2' x 4' Ceiling Tile with “small length horizontal fissures and sparse small pinholes” pattern</b>	<b>PC 3.3% Chrysotile</b>
ACT-F-01	Corridor 1.C01	2' x 4' Ceiling Tile with “light medium horizontal fissures and dense small pinholes” pattern. Fire Code 220 stickers on back of tiles.	None Detected
ACT-F-02	Corridor 1.C01	2' x 4' Ceiling Tile with “light medium horizontal fissures and dense small pinholes” pattern. Fire Code 220 stickers on back of tiles.	None Detected
ACT-F-03	Corridor 1.C01	2' x 4' Ceiling Tile with “light medium horizontal fissures and dense small pinholes” pattern. Fire Code 220 stickers on back of tiles.	None Detected



Sample #	Location	Description	Asbestos Content
ACT-G-01	Room 1.20 – C.L.N.	2' x 4' Ceiling Tile with “large deep horizontal fissures and large evenly spaced pinholes” pattern. Fissured 219 stickers on back of tiles.	None Detected
ACT-G-02	Room 1.20 – C.L.N.	2' x 4' Ceiling Tile with “large deep horizontal fissures and large evenly spaced pinholes” pattern. Fissured 219 stickers on back of tiles.	None Detected
ACT-G-03	Room 1.20 – C.L.N.	2' x 4' Ceiling Tile with “large deep horizontal fissures and large evenly spaced pinholes” pattern. Fissured 219 stickers on back of tiles.	None Detected
<b>Cellulose -01</b>	<b>Room 1.31 – Girls Washroom</b>	<b>Cellulose Pipe Insulation</b>	<b>PC 1.2% Chrysotile</b>
		Tan Pipe Wrap	None Detected
<b>Cellulose -02</b>	<b>Room 1.31 – Girls Washroom</b>	<b>Cellulose Pipe Insulation</b>	<b>ANR</b>
		Tan Pipe Wrap	None Detected
<b>Cellulose -03</b>	<b>Room 1.31 – Girls Washroom</b>	<b>Cellulose Pipe Insulation</b>	<b>ANR</b>
DuctConnector-02	Room 2.10 – Upper Fan Room above Janitors Room	Flex Connector	None Detected
DuctConnector-03	Room 2.10 – Upper Fan Room above Janitors Room	Flex Connector	None Detected

ANR – Analysis Not Required – Material Known to Be Asbestos-Containing  
PC – Point Counting

## 6.1 Texture Finishes

Texture finish was observed applied to the ceilings within Rooms 1.01 - 1.06, 1.08, 1.09, 1.51, 2.03, 2.05 – 2.09, 2.12 (Classrooms and Vestibules), 1.30 (Gym) and the 2<sup>nd</sup> Floor Corridor. Samples were previously collected and were found to contain 3% *Chrysotile* asbestos. All of the ceiling texture finish observed within the school was found to be in good condition and therefore assigned a Priority 2.



## 6.2 Mechanical Insulation

### 6.2.1 Linear Pipe Insulation

Linear mechanical pipe insulation was observed in several locations throughout the surveyed area. During the 2011 reassessment, suspect asbestos-containing linear pipe insulation was sampled and analyzed using the PLM method of detection as follows:

- Samples AirCell-01/02/03 were collected of Aircell pipe insulation from above the suspended ceiling in Corridor 1.C02. The samples were found to contain 45% *Chrysotile* asbestos.
- Samples Cellulose-01/02/03 were collected of cellulose pipe insulation from above the solid suspended ceiling in the Girls Washroom (Location 1.31). A tan pipe wrap component was also analyzed. The samples were found to contain 1.2% *Chrysotile* asbestos. No asbestos was detected in the tan pipe wrap component.

Asbestos-containing linear pipe insulation was observed within Room 1.31 (Girls Washroom) and Corridor 1.C02. Linear Aircell pipe insulation observed in 1.C02 was assigned a Priority 1 and was removed by Wayne and Harold Smith Construction in 2011. All remaining asbestos-containing linear pipe insulation was observed to be in good condition and assigned a Priority 2.

Asbestos-containing linear mechanical pipe insulation should be assumed to be present above all solid suspended ceilings where access is limited.

### 6.2.2 Pipe Fitting Insulation

Mechanical pipe fitting insulation, previously sampled and found to contain 40% *Chrysotile* asbestos, was observed within the following rooms: 1.31 (Girls Washroom), 1.33 (Storage), 1.39 (Custodial Room), 1.42 (Electrical), 1.43 (Boiler Room), and in Corridors 1.C05 and 1.C06.

Asbestos-containing pipe fittings were noted in poor condition and assigned a Priority 1 in Room 1.31 (Girls Washroom) and the Corridor 1.C05 and were repaired in 2011 (Priority 2). All remaining pipe fittings were observed to be in good condition and assigned a Priority 2.

During the 2008 reassessment, pipe fittings observed below the ceiling in Room 1.33 were noted to have been removed. During the 2009 reassessment, pipe fittings observed above the ceiling in Room 1.33 were noted to have been removed.

Asbestos-containing mechanical pipe fitting insulation should be assumed to be present above all solid suspended ceilings where access is limited.

## 6.3 Ceiling Tiles

2' x 4' ceiling tiles were observed throughout the surveyed area. Previously, samples were collected and were found to contain 10% *Chrysotile* asbestos. The tiles were noted to be in good





condition and thus assigned a Priority 2. During the 2008 reassessment, the custodian reported that many of the ceiling tiles have been replaced within the corridor. During the 2011 reassessment, samples of the various types of acoustic ceiling tiles were collected and submitted for analysis using the PLM method of detection as follows:

- Samples ACT-A-01/02/03 were collected of 2' x 4' ceiling tile with "small length horizontal fissures, small pinholes and small dents" pattern. The samples were found to contain 2.8% *Chrysotile* asbestos.
- Samples ACT-B-01/02/03 were collected of 2' x 4' ceiling tile with "medium length horizontal fissures and small/medium pinholes" pattern. A dotted pattern reading <<< 7 12 6 <<< is present on the back of the tiles. No asbestos was detected in the samples.
- Samples ACT-C-01/02/03 were collected of 2' x 4' ceiling tile with "small 'y' shaped fissures and small pinholes" pattern. No asbestos was detected in the samples.
- Samples ACT-D-01/02/03 were collected of 2' x 4' ceiling tile with "small length horizontal fissures and sparse small pinholes" pattern. The samples were found to contain 3.3% *Chrysotile* asbestos.
- ACT-E described as 2' x 4' ceiling tile with "small length horizontal fissures and dense pinholes" pattern were observed to have a 1995 date stamp reading '9/12/95' thus were not sampled as they are not suspected to contain asbestos.
- Samples ACT-F-01/02/03 were collected of 2' x 4' ceiling tile with "light medium horizontal fissures and dense small pinholes" pattern. Fire Code 220 stickers were observed on the back of tiles. No asbestos was detected in the samples.
- Samples ACT-G-01/02/03 were collected of 2' x 4' Ceiling Tile with "large deep horizontal fissures and large evenly spaced pinholes" pattern. Fissured 219 stickers were observed on the back of tiles. No asbestos was detected in the samples.

Asbestos-containing acoustic ceiling tiles were observed within Rooms 1.10 (Office), 1.11 (Health Room), 1.12 (Staff Room), 1.13 (Vice Principal), 1.15 (Early Years), 1.17 Vestibule, 1.18, 1.19, 1.20 (C.L.N. Room, Office and Storage), 1.23, 1.25 (Classrooms), 1.31 (Girls Washroom), 1.33 (Storage), 1.34 (C.L.N.), 1.38 (Girls Change Room), 1.44 (Boys Change Room), 1.48 (Classroom), Corridors 1.C01, 1.C02, 1.C03, 1.C04, 1.C05, 1.C06, 1.C07, 2.13 (Library), 2.14 (Workroom), 2.15 (Computer Area), 2.16 (Special Education Resource), 2.17 (Guidance). All asbestos-containing acoustic ceiling tiles were observed to be in good condition and assigned a Priority 2.

#### 6.4 Vinyl Floor Tiles

9" and 1' vinyl floor tiles were observed in several locations throughout the school. Previously, a sample of 9" x 9" tile was collected from Room 2.12 (Classroom) and was found to contain



6.5% *Chrysotile* asbestos. No other vinyl floor tiles were sampled for asbestos content as based on the age of the building all floor tiles are considered to contain asbestos until proven otherwise. All vinyl floor tiles were found to be in good condition and therefore assigned a Priority 2.

Given the composition of vinyl floor products, the PLM analysis method is often prone to yielding false negative analysis results. Therefore we recommend that Transmission Electron Microscopy (TEM) analysis method be used to determine the asbestos content within all vinyl floor tiles.

## **6.5 Vinyl Sheet Flooring**

Vinyl sheet flooring (VSF) was observed in Room 1.11 (Health Room). The vinyl sheet flooring was not sampled for asbestos content as based on the age of the building the sheet flooring was considered to contain asbestos. However, no vinyl sheet flooring was observed within the building during the current reassessment. VSF previously identified in Room 1.11 (Health Room) has been replaced with 1' x 1' vinyl floor tile.

## **6.6 Caulking**

Caulking (windows, doors, etc.) was observed within several areas of the school. As reported by Mr. Rau of AMDSB, all windows have been replaced in recent years and thus the caulking is not suspected of containing asbestos. All other caulking must be considered as asbestos-containing until proven otherwise.

## **6.7 Other**

Heat shields in light fixtures were observed in Rooms 1.11 (Health Room Washroom) and in the washrooms of Room 1.15 (Early Years). During the 2004 survey, the heat shield material in Room 1.11 was sampled and was found to contain 99% *Chrysotile* asbestos. The same type of heat shield was found in Room 1.15. Based on their condition, the heat shields were assigned a Priority 1. Mr. Mike Rau confirmed that Wayne and Harold Smith Construction removed the heat shields.

During the 2004 original survey, samples of flex duct connector were sampled from Room 2.10 (Upper Fan Room). During the 2011 survey, two additional samples DuctConnector-02/03 were collected and submitted for analysis using the PLM method of detection. No asbestos was detected in the samples.

During the 2011 survey, a Transite pipe was observed in Room 1.38 (Girls Change Room). No samples were collected as this material is known to be asbestos-containing. Asbestos-containing Transite pipe was observed to be in good condition and assigned a Priority 2.



## 7.0 CONCLUSIONS AND RECOMMENDATIONS

Based on the investigation conducted by T. Harris Environmental Management, the following Table summarizes the findings of the re-assessment of all the asbestos-containing materials. Materials which have been removed are italicized.

**TABLE 5**  
**Summary of Re-Assessment of Asbestos-Containing Materials**  
**Victoria Public School**  
**Goderich, Ontario**  
**August 22<sup>nd</sup>, 2011**

Location Description	Material	Quantity	Priority	Type(s) of Asbestos	Friable (Y/N)	Photograph
Room 1.10 – Office	2' x 4' Ceiling Tile	518 ft <sup>2</sup>	2	Chrysotile	N/A	--
Room 1.11 – Health Room	2' x 4' Ceiling Tile	208 ft <sup>2</sup>	2	Chrysotile	N/A	--
Room 1.12 – Staff Room	2' x 4' Ceiling Tile	336 ft <sup>2</sup>	2	Chrysotile	N/A	--
Room 1.13 – Vice Principal	2' x 4' Ceiling Tile	138 ft <sup>2</sup>	2	Chrysotile	N/A	--
Room 1.15 – Early Years	2' x 4' Ceiling Tile	1046 ft <sup>2</sup>	2	Chrysotile	N/A	--
Room 1.17 – Vestibule	2' x 4' Ceiling Tile	296 ft <sup>2</sup>	2	Chrysotile	N/A	--
Room 1.18 – Storage	2' x 4' Ceiling Tile	78 ft <sup>2</sup>	2	Chrysotile	N/A	--
Room 1.19 – Office	2' x 4' Ceiling Tile	96 ft <sup>2</sup>	2	Chrysotile	N/A	--
Room 1.20 – C.L.N.	2' x 4' Ceiling Tile	N/A**	2	Chrysotile	N/A	--
Room 1.23 - Classroom	2' x 4' Ceiling Tile	783 ft <sup>2</sup>	2	Chrysotile	N/A	--
Room 1.31 – Girls Washroom	2' x 4' Ceiling Tile	241 ft <sup>2</sup>	2	Chrysotile	N/A	--
Room 1.33 – Storage	2' x 4' Ceiling Tile	204 ft <sup>2</sup>	2	Chrysotile	N/A	--
Room 1.34 – C.L.N.	2' x 4' Ceiling Tile	1192 ft <sup>2</sup>	2	Chrysotile	N/A	--
Room 1.38 – Girls Change Room	2' x 4' Ceiling Tile	548 ft <sup>2</sup>	2	Chrysotile	N/A	--
Room 1.44 – Boys Change Room	2' x 4' Ceiling Tile	N/A**	2	Chrysotile	N/A	--
Room 1.48 – Classroom	2' x 4' Ceiling Tile	N/A**	2	Chrysotile	N/A	--
Room 2.13 – Library	2' x 4' Ceiling Tile	N/A**	2	Chrysotile	N/A	--
Room 2.14 – Workroom	2' x 4' Ceiling Tile	208 ft <sup>2</sup>	2	Chrysotile	N/A	--
Room 2.15 – Computer Area	2' x 4' Ceiling Tile	N/A**	2	Chrysotile	N/A	--



<b>Location Description</b>	<b>Material</b>	<b>Quantity</b>	<b>Priority</b>	<b>Type(s) of Asbestos</b>	<b>Friable (Y/N)</b>	<b>Photograph</b>
Room 2.16 – Special Education Resource	2' x 4' Ceiling Tile	N/A**	2	Chrysotile	N/A	--
Room 2.17 – Guidance	2' x 4' Ceiling Tile	333 ft <sup>2</sup>	2	Chrysotile	N/A	--
Corridor 1.C01	2' x 4' Ceiling Tile	N/A**	2	Chrysotile	N/A	--
Corridor 1.C02	2' x 4' Ceiling Tile	N/A**	2	Chrysotile	N/A	--
Corridor 1.C03	2' x 4' Ceiling Tile	N/A**	2	Chrysotile	N/A	--
Corridor 1.C04	2' x 4' Ceiling Tile	N/A**	2	Chrysotile	N/A	--
Corridor 1.C05	2' x 4' Ceiling Tile	N/A**	2	Chrysotile	N/A	--
Corridor 1.C06	2' x 4' Ceiling Tile	N/A**	2	Chrysotile	N/A	--
Corridor 1.C07	2' x 4' Ceiling Tile	N/A**	2	Chrysotile	N/A	--
Room 1.01 – Classroom	Texture Finish	766 ft <sup>2</sup>	2	Chrysotile	Yes	--
Room 1.02 – Classroom	Texture Finish	763 ft <sup>2</sup>	2	Chrysotile	Yes	--
Room 1.03 - Vestibule	Texture Finish	276 ft <sup>2</sup>	2	Chrysotile	Yes	--
Room 1.04 – Classroom	Texture Finish	757 ft <sup>2</sup>	2	Chrysotile	Yes	--
Room 1.01 – Classroom	Texture Finish	765 ft <sup>2</sup>	2	Chrysotile	Yes	--
Room 1.05 – Classroom	Texture Finish	765 ft <sup>2</sup>	2	Chrysotile	Yes	--
Room 1.06 – Classroom	Texture Finish	764 ft <sup>2</sup>	2	Chrysotile	Yes	--
Room 1.08 - Vestibule	Texture Finish	502 ft <sup>2</sup>	2	Chrysotile	Yes	--
Room 1.09 – Classroom	Texture Finish	849 ft <sup>2</sup>	2	Chrysotile	Yes	--
Room 1.30 – Gym	Texture Finish	2819 ft <sup>2</sup>	2	Chrysotile	Yes	--
Room 1.51 – Workroom	Texture Finish	~ 100 ft <sup>2</sup>	2	Chrysotile	Yes	--
2 <sup>nd</sup> Floor Corridor	Texture Finish	--	2	Chrysotile	Yes	--
Room 2.03 – Classroom	Texture Finish	878 ft <sup>2</sup>	2	Chrysotile	Yes	--
Room 2.05 – Classroom	Texture Finish	873 ft <sup>2</sup>	2	Chrysotile	Yes	--
Room 2.06 – Vestibule	Texture Finish	281 ft <sup>2</sup>	2	Chrysotile	Yes	--
Room 2.07 – Classroom	Texture Finish	869 ft <sup>2</sup>	2	Chrysotile	Yes	--
Room 2.08 – Classroom	Texture Finish	872 ft <sup>2</sup>	2	Chrysotile	Yes	--
Room 2.09 – Classroom	Texture Finish	871 ft <sup>2</sup>	2	Chrysotile	Yes	--



Location Description	Material	Quantity	Priority	Type(s) of Asbestos	Friable (Y/N)	Photograph
Room 2.12 - Classroom	Texture Finish	901 ft <sup>2</sup>	2	Chrysotile	Yes	--
Room 1.31 – Girls Washroom	Linear Pipe Insulation	~ 20 ft.	2	Chrysotile	Yes	1
<i>Corridor 1.C02</i>	<i>Linear Pipe Insulation</i>	<i>REMOVED 2011</i>	2	<i>Chrysotile</i>	<i>Yes</i>	2
Corridor 1.C05	Pipe Fitting	23	2	Chrysotile	Yes	3
Corridor 1.C06	Pipe Fitting	10	2	Chrysotile	Yes	--
Room 1.31 – Girls Washroom	Pipe Fitting	12	2	Chrysotile	Yes	4
<i>Room 1.33 – Storage (below ceiling)</i>	<i>Pipe Fitting</i>	<i>REMOVED 2007/08</i>	--	--	--	--
<i>Room 1.33 – Storage (above ceiling)</i>	<i>Pipe Fitting</i>	<i>REMOVED 2008/09</i>	--	--	--	--
Room 1.39 – Custodian	Pipe Fitting	7	2	Chrysotile	Yes	--
Room 1.42 – Electrical Room	Pipe Fitting	4	2	Chrysotile	Yes	--
Room 1.43 – Boiler Room	Pipe Fitting	30	2	Chrysotile	Yes	--
Room 1.38 – Girls Change Room	*Transite Pipe	8 ft.	2	--	No	--
<i>Room 1.11 – Health Room (Washroom)</i>	<i>Light Fixture Heat Shield</i>	<i>REMOVED 2008/09</i>	--	--	--	--
<i>Room 1.15 – Early Years (Washroom)</i>	<i>Light Fixture Heat Shield</i>	<i>REMOVED 2008/09</i>	--	--	--	--
Room 2.03 – Classroom	*9" x 9" Vinyl Floor Tiles	878 ft <sup>2</sup>	2	--	No	--
Room 2.04 – Workroom	*9" x 9" Vinyl Floor Tiles	242 ft <sup>2</sup>	2	--	No	--
Room 2.07 – Classroom	*9" x 9" Vinyl Floor Tiles	869 ft <sup>2</sup>	2	--	No	--
Room 2.08 – Classroom	9" x 9" Vinyl Floor Tiles	872 ft <sup>2</sup>	2	Chrysotile	No	--
Room 2.09 – Classroom	9" x 9" Vinyl Floor Tiles	871 ft <sup>2</sup>	2	Chrysotile	No	--
Room 2.12 – Classroom	9" x 9" Vinyl Floor Tiles	901 ft <sup>2</sup>	2	Chrysotile	No	--
Room 1.01 – Classroom	*1' x 1' Vinyl Floor Tiles	766 ft <sup>2</sup>	2	--	No	--
Room 1.02 – Classroom	*1' x 1' Vinyl Floor Tiles	763 ft <sup>2</sup>	2	--	No	--
Room 1.04 – Classroom	*1' x 1' Vinyl Floor Tiles	757 ft <sup>2</sup>	2	--	No	--
Room 1.05 – Classroom	*1' x 1' Vinyl Floor Tiles	765 ft <sup>2</sup>	2	--	No	--
Room 1.06 – Classroom	*1' x 1' Vinyl Floor Tiles	764 ft <sup>2</sup>	2	--	No	--
Room 1.09 – Classroom	*1' x 1' Vinyl Floor Tiles	849 ft <sup>2</sup>	2	--	No	5



<b>Location Description</b>	<b>Material</b>	<b>Quantity</b>	<b>Priority</b>	<b>Type(s) of Asbestos</b>	<b>Friable (Y/N)</b>	<b>Photograph</b>
Room 1.10 – Office Workroom	*1' x 1' Vinyl Floor Tiles	--	2	--	No	--
Room 1.11 – Health Room	*1' x 1' Vinyl Floor Tiles	208 ft <sup>2</sup>	2	--	No	--
Room 1.15 – Classroom	*1' x 1' Vinyl Floor Tiles	~ 500 ft <sup>2</sup>	2	--	No	--
Room 1.18 – C.L.N. Storage	*1' x 1' Vinyl Floor Tiles	78 ft <sup>2</sup>	2	--	No	--
Room 1.19 – C.L.N. Office	*1' x 1' Vinyl Floor Tiles	96 ft <sup>2</sup>	2	--	No	--
Room 1.20 – C.L.N.	*1' x 1' Vinyl Floor Tiles	838 ft <sup>2</sup>	2	--	No	--
Room 1.21 – Early Years	*1' x 1' Vinyl Floor Tiles	~ 350 ft <sup>2</sup>	2	--	No	--
Room 1.23 – Classroom	*1' x 1' Vinyl Floor Tiles	783 ft <sup>2</sup>	2	--	No	--
Room 1.24 – Boys' Washroom	*1' x 1' Vinyl Floor Tiles	92 ft <sup>2</sup>	2	--	No	--
Room 1.25 – Classroom	*1' x 1' Vinyl Floor Tiles	805 ft <sup>2</sup>	2	--	No	--
Room 1.33 – Storage	*1' x 1' Vinyl Floor Tiles	204 ft <sup>2</sup>	2	--	No	--
Room 1.34 – C.L.N	*1' x 1' Vinyl Floor Tiles	~ 500 ft <sup>2</sup>	2	--	No	--
Room 1.48 – Classroom	*1' x 1' Vinyl Floor Tiles	898 ft <sup>2</sup>	2	--	No	--
Room 1.51 – Workroom	*1' x 1' Vinyl Floor Tiles	~ 100 ft <sup>2</sup>	2	--	No	--
Corridor 1.C04	*1' x 1' Vinyl Floor Tiles	--	2	--	No	--
Room 2.05 – Classroom	*1' x 1' Vinyl Floor Tiles	873 ft <sup>2</sup>	2	--	No	--
Room 2.15 – Computer Area	*1' x 1' Vinyl Floor Tiles	--	2	--	No	--
Room 2.16 – Special Education Resource	*1' x 1' Vinyl Floor Tiles	--	2	--	No	--
Corridor 2.C01	*1' x 1' Vinyl Floor Tiles	--	2	--	No	--

\*- Materials assumed to contain asbestos until proven otherwise

\*\* - Asbestos-containing acoustic ceiling tiles can not be quantified due to several types of tile being present

Based on the findings of this report THEM recommends the following:

- Friable asbestos-containing materials assigned a Priority 1 (if applicable) must be removed and/or repaired immediately following applicable asbestos abatement procedures. Friable asbestos-containing materials assigned a Priority 2 can remain in place until major system upgrading, maintenance or demolition which could result in disturbance of this material. In the event the friable asbestos-containing materials are removed, Type III asbestos abatement procedures apply as outlined in Ontario Regulation 278/05, Regulation respecting Asbestos on Construction Projects and in Buildings and Repair Operations – made under the Ontario



Occupational Health and Safety Act. Type II asbestos abatement procedures can be applied for the repair of damaged mechanical pipe insulation or, the removal of less than 1 square metre of friable asbestos-containing materials. In addition, Type II Glovebag asbestos abatement procedures can be applied for the removal of asbestos-containing mechanical pipe insulation fittings as outlined in Ontario Regulation 278/05.

- Non-friable asbestos-containing materials assigned a Priority 2 can remain in place until major system upgrading, maintenance or demolition which could result in disturbance of this material. In the event the non-friable asbestos-containing materials are removed, Type I asbestos abatement procedures apply (provided that the material is wetted down and removed using non-powered hand held tools) as outlined in Ontario Regulation 278/05, Regulation respecting Asbestos on Construction Projects and in Buildings and Repair Operations – made under the Ontario Occupational Health and Safety Act.
- Asbestos-containing suspended ceiling tiles assigned a Priority 2, can remain in place until major system upgrading, maintenance or demolition which could result in disturbance of this material. In the event the asbestos-containing ceiling tiles are removed, Type I operations apply for the removal of <7.5 square metres of suspended ceiling tiles, otherwise removal of >7.5 square metres of suspended ceiling tiles must be conducted following Type II operations as outlined in Ontario Regulation 278/05, Regulation respecting Asbestos on Construction Projects and in Buildings and Repair Operations – made under the Ontario Occupational Health and Safety Act
- Respiratory protection equipment worn by contractors conducting abatement activities should be selected based on Table 2 Respirators found in Ontario Regulation 278/05
- In the event all asbestos material within the building is not removed, an asbestos management program must be implemented according to Ontario Regulation 278/05.
- Vinyl floors tiles were analysed using the PLM method of detection as required by Ontario Regulation 278/05. However, given the composition of vinyl floor products, the PLM analysis method is often prone to yielding false negative analysis results. Therefore it may be prudent that the Transmission Electron Microscopy (TEM) analysis method be used to determine the asbestos content in the vinyl floor tiles.

All asbestos repair or removal must be conducted according to Ontario Regulation 278/05, Regulation respecting Asbestos on Construction Projects and in Buildings and Repair Operations - made under the Occupational Health and Safety Act. Asbestos-containing waste has to be handled and disposed of according to Ontario Regulation 347/90 as amended – made under the Environmental Protection Act.



## 8.0 LIMITATIONS

In this statement of limitations, the “Client” refers to the persons or entities to whom this report is addressed. “THEM” refers to T. Harris Environmental Management Inc. The “Contract” refers to any general, or project-specific written agreement, including project-specific scope of work documents, executed between THEM and the Client pertaining to the subject matter of this report.

This report is subject to the limitations set out below and any other limitations set out in the body of this report or in the Contract between THEM and the Client.

The investigation and assessment described in this report were conducted in accordance with the Contract agreed upon by the Client in a manner consistent with a reasonable level of care and skill normally exercised by members of the occupational hygiene consulting profession currently practising under similar conditions in the Province of Ontario and observing the code of ethics of the Canadian Registration Board of Occupational Hygiene (CRBOH) and the American Board of Industrial Hygiene (ABIH).

In preparing this report, THEM has relied on information provided by others, including without limitation, information concerning the history and operation of the site, and test results and analyses of other consultants, independent laboratories, or testing services. Except as expressly stated in this report, THEM has not made any independent verification of such information. Findings cannot be extended to portions of the site, which were unavailable for direct observation.

The assessment in this report has been made in the context of regulations which were in force and effect at the time of the assessment and which are specified in this report. The assessment did not take into account any regulations, which were not in effect at the date of the assessments, or any guideline or standard not specified in this report. Regulatory standards do not exist for all materials of a potentially hazardous nature.

The collection of any samples at the site (including the location of samples and the analytical parameters applied to the samples) was undertaken in accordance with the Contract agreed upon by the Client, based upon the information provided to THEM by the Client concerning existing site conditions. Conditions between sample locations (if any) may differ from those indicated in this report.

This report is intended solely for the use or uses specified in this report and/or the Contract. Use of this report for purposes other than those set out in this report and/or the Contract will be at the sole risk of the Client.

Copying of this report except as may be reasonably required for internal use by the Client and any distribution of this report to persons other than the Client in whole or in part, is not permitted without the express written permission of THEM.





**This report is for the sole use of the Client. THEM makes no representation or warranty, either expressed or implied, to any third party with regard to this report and the work referred to in this report and expressly disclaims any, and accepts no duty of care to any third party or any responsibility or liability whatsoever to any third party for any loss, expenses, damages (direct, consequential or contingent), fines, penalties, or other harm that may be suffered or incurred by any third party as a result of any use of, any reliance placed upon, or any decision made or actions taken based upon this report or the work referred to herein.**

In no event shall THEM be liable for any indirect, incidental, special or consequential damages, or damages from loss of profits, revenue, or use, incurred by either the client or any third party, whether in an action in tort or contract, even if THEM has been advised of the possibility of such damages. THEM's liability for damages shall in no event exceed the limit of available insurance coverage.

If new information concerning the subject matter of this report arises, THEM should be contacted to re-evaluate the conclusions of this report and to provide amendments as required.

Should you have any questions or comments regarding this survey, please do not hesitate to contact our office.

Sincerely,

**T. HARRIS ENVIRONMENTAL MANAGEMENT INC.**

---

Joe D'Angelo, B.A.(Env. Studies), EPT  
Environmental/OH&S Technician

---

Greg Balsden, B.Sc., AMRT.  
Project Manager - Southwestern Ontario



---

**APPENDIX I  
SITE PHOTOGRAPHS**

---



Photograph 1: Asbestos-containing linear pipe insulation and pipe fittings above the suspended solid ceiling in Room 1.31 – Girls Washroom. Pipe fittings identified as Priority 1's were repaired in 2011.



Photograph 2: Asbestos-containing AirCell pipe insulation with exposed ends in Corridor 1.C02 was removed in 2011.



Photograph 3: Asbestos-containing pipe fittings in Corridor 1.C05. Two fittings observed to be in poor condition were repaired in 2011 (Priority 2).



Photograph 4: Asbestos-containing pipe fittings above the suspended solid ceiling in Room 1.31 – Girls Washroom. Three fittings were observed to be in poor condition and were repaired in 2011 (Priority 2).



Photograph 5: Assumed asbestos-containing vinyl floor tiles in poor condition in Room 1.09 – Classroom were repaired in 2011 (Priority 2).



---

---



**APPENDIX II  
FLOOR PLANS**

---

---

# Legend

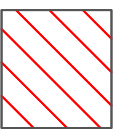
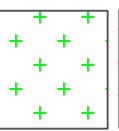
Original Drawing Modified by T. Harris  
Environmental Management Inc.

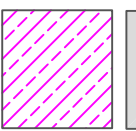
-  Asbestos-containing Mechanical Insulation
-  Asbestos-containing Texture Coat
-  Asbestos-containing Vinyl Floor Tile
-  Asbestos-containing Acoustic Ceiling Tile

## Notes:

Asbestos-containing mechanical pipe and pipe fitting insulation is suspected present above all solid suspended ceilings.

More than 1 sample name for a sample location indicates more than 1 sample collected within that room.

Hatched areas indicate rooms with specific ACM's, and does not indicate the amount of ACM within that room.

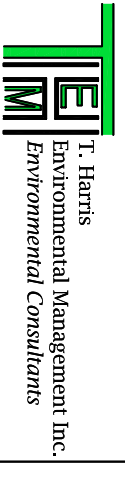

**Victorial P.S.**  
135 Gibbons Street  
Goderich, Ontario

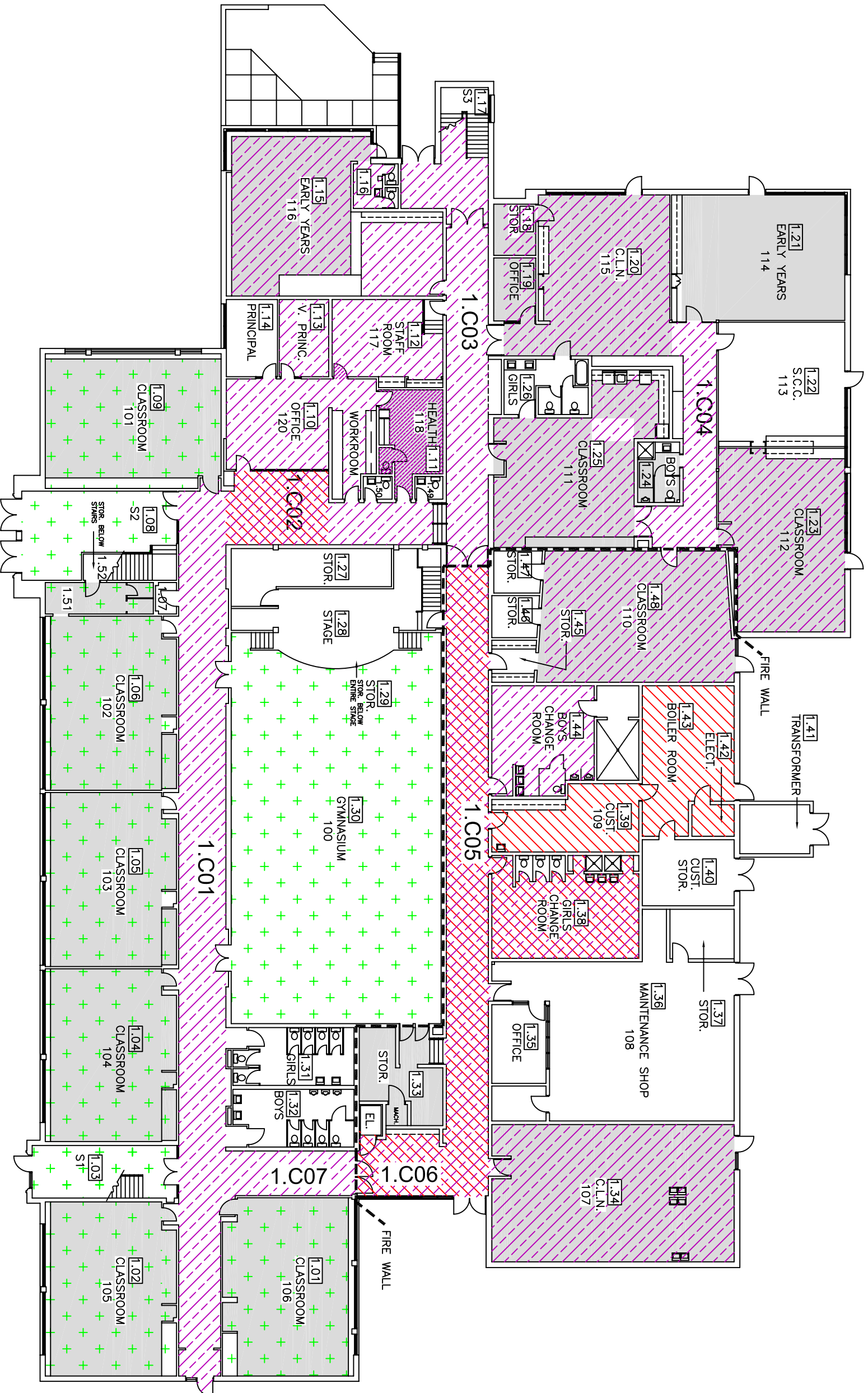

## Main Floor



SCALE: N.T.S. DATE: 06/21/11 PREPARED BY: JD/GB

# Legend

Original Drawing Modified by T. Harris  
Environmental Management Inc.

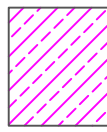
-  Asbestos-containing Mechanical Insulation
-  Asbestos-containing Texture Coat
-  Asbestos-containing Vinyl Floor Tile
-  Asbestos-containing Acoustic Ceiling Tile

## Notes:

Asbestos-containing mechanical pipe and pipe fitting insulation is suspected present above all solid suspended ceilings.

More than 1 sample name for a sample location indicates more than 1 sample collected within that room.

Hatched areas indicate rooms with specific ACM's, and does not indicate the amount of ACM within that room.

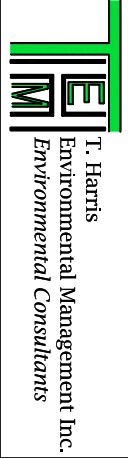

**Victorial P.S.**  
135 Gibbons Street  
Goderich, Ontario

## Second Floor

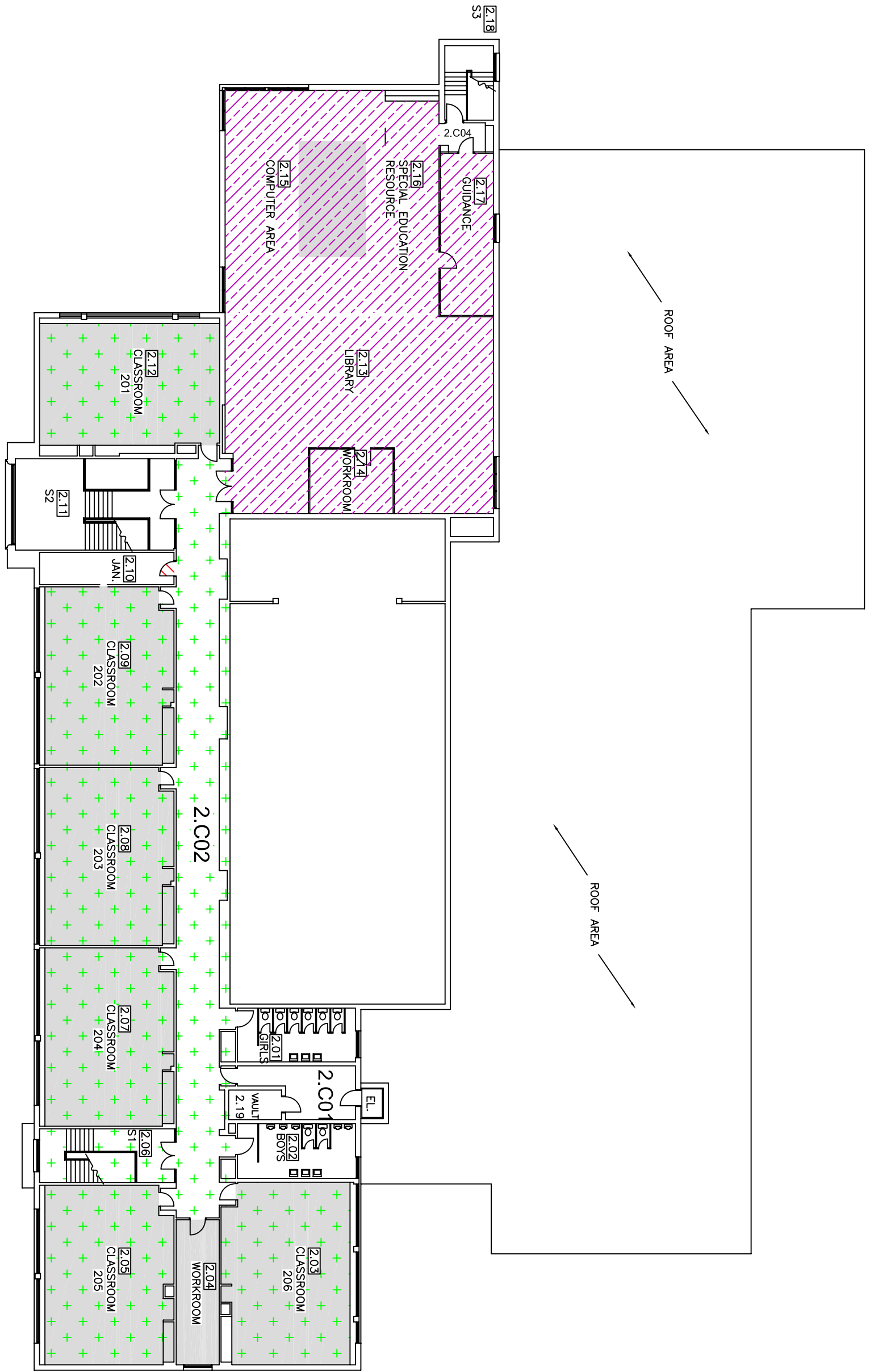

SCALE: N.T.S. DATE: 06/21/11 PREPARED BY: JD/GB





---

**APPENDIX III**  
**LABORATORY CERTIFICATES OF ANALYSIS**

---

## CERTIFICATE OF ANALYSIS

**Client:** T. Harris Environmental  
931 Commissioners Rd E St.100  
London Ontario Canada N5Z3H9

**Report Date:** 6/14/2011  
**Report No.:** 242527  
**Project:** Victoria PS Reassessment  
**Project No.:** 11-1707-48

### BULK SAMPLE ANALYSIS SUMMARY

**Lab No.:** 4327383      **Description / Location:** Off-White Insulation  
**Client No.:** AirCell-01      Corridor (Locaton 1.C02)

<u>% Asbestos</u>	<u>Type</u>	<u>% Non-Asbestos Fibrous Material</u>	<u>Type</u>	<u>% Non-Fibrous Material</u>
45	Chrysotile	25	Cellulose	20
		10	Fibrous Glass	

**Lab No.:** 4327384      **Description / Location:** Sample Not Analyzed  
**Client No.:** AirCell-02

<u>% Asbestos</u>	<u>Type</u>	<u>% Non-Asbestos Fibrous Material</u>	<u>Type</u>	<u>% Non-Fibrous Material</u>
Sample Not Analyzed		Sample Not Analyzed		

**Lab No.:** 4327385      **Description / Location:** Sample Not Analyzed  
**Client No.:** AirCell-03

<u>% Asbestos</u>	<u>Type</u>	<u>% Non-Asbestos Fibrous Material</u>	<u>Type</u>	<u>% Non-Fibrous Material</u>
Sample Not Analyzed		Sample Not Analyzed		

**Lab No.:** 4327386      **Description / Location:** Lt.Tan Ceiling Tile  
**Client No.:** ACT-A-01      Library (Location 2.13)

<u>% Asbestos</u>	<u>Type</u>	<u>% Non-Asbestos Fibrous Material</u>	<u>Type</u>	<u>% Non-Fibrous Material</u>
PC 2.8	Amosite	55	Fibrous Glass	PC 42.2

**Accreditations:**      **NIST-NVLAP No. 101165-0**      **NY-DOH No. 11021**      **AIHA-LAP, LLC No. 100188**  
*This confidential report relates only to those item(s) tested and does not represent an endorsement by NIST-NVLAP, AIHA or any agency of the U.S. government  
This report shall not be reproduced except in full, without written approval of the laboratory.*

**Analytical Method**      EPA 600/R-93/116

**Comments:** (PC) Indicates Stratified Point Count Method performed. Method not performed unless stated. Quantification at <0.25% by volume is possible with this method. (PC-Trace) represents this limit of quantitation. (PC-Trace) means that asbestos was detected but is not quantifiable under the Point Counting regimen. Analysis includes all distinct separable layers in accordance with EPA 600 Method. If not reported or otherwise noted, layer is either not present or the client has specifically requested that it not be analyzed. Small asbestos fibers may be missed by PLM due to resolution limitations of the optical microscope. Therefore, negative PLM results cannot be guaranteed. Electron Microscopy can be used as a confirming technique. Regulatory Limit is based upon the sample matrix.

**Analysis Performed By:**      E. Smith

**Approved By:** \_\_\_\_\_

**Date:**      6/14/2011

Frank E. Ehrenfeld, III  
Laboratory Director

## CERTIFICATE OF ANALYSIS

<b>Client:</b> T. Harris Environmental 931 Commissioners Rd E St.100 London Ontario Canada N5Z3H9	<b>Report Date:</b> 6/14/2011 <b>Report No.:</b> 242527 <b>Project:</b> Victoria PS Reassessment <b>Project No.:</b> 11-1707-48
---	--

### BULK SAMPLE ANALYSIS SUMMARY

<b>Lab No.:</b> 4327387	<b>Description / Location:</b> Sample Not Analyzed		
<b>Client No.:</b> ACT-A-02			
<u>% Asbestos</u>	<u>Type</u>	<u>% Non-Asbestos Fibrous Material</u>	<u>Type</u>
Sample Not Analyzed		Sample Not Analyzed	

<b>Lab No.:</b> 4327388	<b>Description / Location:</b> Sample Not Analyzed		
<b>Client No.:</b> ACT-A-03			
<u>% Asbestos</u>	<u>Type</u>	<u>% Non-Asbestos Fibrous Material</u>	<u>Type</u>
Sample Not Analyzed		Sample Not Analyzed	

<b>Lab No.:</b> 4327389	<b>Description / Location:</b> Tan Ceiling Tile		
<b>Client No.:</b> ACT-B-01	Library (Location 2.13)		
<u>% Asbestos</u>	<u>Type</u>	<u>% Non-Asbestos Fibrous Material</u>	<u>Type</u>
None Detected	None Detected	35	Cellulose
		20	Fibrous Glass
		1	Wollastonite
			44

<b>Lab No.:</b> 4327390	<b>Description / Location:</b> Tan Ceiling Tile		
<b>Client No.:</b> ACT-B-02	Library (Location 2.13)		
<u>% Asbestos</u>	<u>Type</u>	<u>% Non-Asbestos Fibrous Material</u>	<u>Type</u>
None Detected	None Detected	35	Cellulose
		20	Fibrous Glass
		1	Wollastonite
			44

**Accreditations:** **NIST-NVLAP No. 101165-0**      **NY-DOH No. 11021**      **AIHA-LAP, LLC No. 100188**  
*This confidential report relates only to those item(s) tested and does not represent an endorsement by NIST-NVLAP, AIHA or any agency of the U.S. government  
 This report shall not be reproduced except in full, without written approval of the laboratory.*

**Analytical Method**      EPA 600/R-93/116

**Comments:** (PC) Indicates Stratified Point Count Method performed. Method not performed unless stated. Quantification at <0.25% by volume is possible with this method. (PC-Trace) represents this limit of quantitation. (PC-Trace) means that asbestos was detected but is not quantifiable under the Point Counting regimen. Analysis includes all distinct separable layers in accordance with EPA 600 Method. If not reported or otherwise noted, layer is either not present or the client has specifically requested that it not be analyzed. Small asbestos fibers may be missed by PLM due to resolution limitations of the optical microscope. Therefore, negative PLM results cannot be guaranteed. Electron Microscopy can be used as a confirming technique. Regulatory Limit is based upon the sample matrix.

**Analysis Performed By:**           E. Smith          

**Date:**           6/14/2011

## CERTIFICATE OF ANALYSIS

<b>Client:</b> T. Harris Environmental 931 Commissioners Rd E St.100 London Ontario Canada N5Z3H9	<b>Report Date:</b> 6/14/2011 <b>Report No.:</b> 242527 <b>Project:</b> Victoria PS Reassessment <b>Project No.:</b> 11-1707-48
---	--

### BULK SAMPLE ANALYSIS SUMMARY

<b>Lab No.:</b> 4327391	<b>Description / Location:</b> Tan Ceiling Tile		
<b>Client No.:</b> ACT-B-03	Janitor's Room (Location 2.10)		
<u>% Asbestos</u>	<u>Type</u>	<u>% Non-Asbestos Fibrous Material</u>	<u>Type</u>
None Detected	None Detected	35	Cellulose
		20	Fibrous Glass
		1	Wollastonite

<b>Lab No.:</b> 4327392	<b>Description / Location:</b> Tan Ceiling Tile		
<b>Client No.:</b> ACT-C-01	Library (Location 2.13)		
<u>% Asbestos</u>	<u>Type</u>	<u>% Non-Asbestos Fibrous Material</u>	<u>Type</u>
None Detected	None Detected	35	Cellulose
		20	

<b>Lab No.:</b> 4327393	<b>Description / Location:</b> Tan Ceiling Tile		
<b>Client No.:</b> ACT-C-02	Library (Location 2.13)		
<u>% Asbestos</u>	<u>Type</u>	<u>% Non-Asbestos Fibrous Material</u>	<u>Type</u>
None Detected	None Detected	35	Cellulose
		20	

<b>Lab No.:</b> 4327394	<b>Description / Location:</b> Tan Ceiling Tile		
<b>Client No.:</b> ACT-C-03	Boys Washroom (Location 1.32)		
<u>% Asbestos</u>	<u>Type</u>	<u>% Non-Asbestos Fibrous Material</u>	<u>Type</u>
None Detected	None Detected	35	Cellulose
		20	

**Accreditations:** **NIST-NVLAP No. 101165-0**      **NY-DOH No. 11021**      **AIHA-LAP, LLC No. 100188**  
*This confidential report relates only to those item(s) tested and does not represent an endorsement by NIST-NVLAP, AIHA or any agency of the U.S. government  
 This report shall not be reproduced except in full, without written approval of the laboratory.*

**Analytical Method**      EPA 600/R-93/116

**Comments:** (PC) Indicates Stratified Point Count Method performed. Method not performed unless stated. Quantification at <0.25% by volume is possible with this method. (PC-Trace) represents this limit of quantitation. (PC-Trace) means that asbestos was detected but is not quantifiable under the Point Counting regimen. Analysis includes all distinct separable layers in accordance with EPA 600 Method. If not reported or otherwise noted, layer is either not present or the client has specifically requested that it not be analyzed. Small asbestos fibers may be missed by PLM due to resolution limitations of the optical microscope. Therefore, negative PLM results cannot be guaranteed. Electron Microscopy can be used as a confirming technique. Regulatory Limit is based upon the sample matrix.

**Analysis Performed By:**      E. Smith

**Date:**      6/14/2011

## CERTIFICATE OF ANALYSIS

<b>Client:</b>	T. Harris Environmental 931 Commissioners Rd E St.100 London Ontario Canada N5Z3H9	<b>Report Date:</b>	6/14/2011
		<b>Report No.:</b>	242527
		<b>Project:</b>	Victoria PS Reassessment
		<b>Project No.:</b>	11-1707-48

### BULK SAMPLE ANALYSIS SUMMARY

<b>Lab No.:</b>	4327395	<b>Description / Location:</b>	Tan Ceiling Tile Corridor (Location 1.C02)	
<b>Client No.:</b>	ACT-D-01			
<u>% Asbestos</u>	<u>Type</u>	<u>% Non-Asbestos Fibrous Material</u>	<u>Type</u>	<u>% Non-Fibrous Material</u>
None Detected	None Detected	35	Cellulose	45
		20		

<b>Lab No.:</b>	4327396	<b>Description / Location:</b>	Tan Ceiling Tile Corridor (Location 1.C02)	
<b>Client No.:</b>	ACT-D-02			
<u>% Asbestos</u>	<u>Type</u>	<u>% Non-Asbestos Fibrous Material</u>	<u>Type</u>	<u>% Non-Fibrous Material</u>
None Detected	None Detected	35	Cellulose	45
		20		

<b>Lab No.:</b>	4327397	<b>Description / Location:</b>	Tan Ceiling Tile Girls Washroom (Location 1.31)	
<b>Client No.:</b>	ACT-D-03			
<u>% Asbestos</u>	<u>Type</u>	<u>% Non-Asbestos Fibrous Material</u>	<u>Type</u>	<u>% Non-Fibrous Material</u>
PC 3.3	Amosite	55	Fibrous Glass	PC 41.7

<b>Lab No.:</b>	4327398	<b>Description / Location:</b>	Tan Ceiling Tile Corridor (Location 1.C01)	
<b>Client No.:</b>	ACT-F-01			
<u>% Asbestos</u>	<u>Type</u>	<u>% Non-Asbestos Fibrous Material</u>	<u>Type</u>	<u>% Non-Fibrous Material</u>
None Detected	None Detected	35	Cellulose	45
		20	Fibrous Glass	

**Accreditations:**      **NIST-NVLAP No. 101165-0**      **NY-DOH No. 11021**      **AIHA-LAP, LLC No. 100188**  
*This confidential report relates only to those item(s) tested and does not represent an endorsement by NIST-NVLAP, AIHA or any agency of the U.S. government  
This report shall not be reproduced except in full, without written approval of the laboratory.*

**Analytical Method**      EPA 600/R-93/116

**Comments:** (PC) Indicates Stratified Point Count Method performed. Method not performed unless stated. Quantification at <0.25% by volume is possible with this method. (PC-Trace) represents this limit of quantitation. (PC-Trace) means that asbestos was detected but is not quantifiable under the Point Counting regimen. Analysis includes all distinct separable layers in accordance with EPA 600 Method. If not reported or otherwise noted, layer is either not present or the client has specifically requested that it not be analyzed. Small asbestos fibers may be missed by PLM due to resolution limitations of the optical microscope. Therefore, negative PLM results cannot be guaranteed. Electron Microscopy can be used as a confirming technique. Regulatory Limit is based upon the sample matrix.

**Analysis Performed By:**                E. Smith          

**Date:**                6/14/2011

## CERTIFICATE OF ANALYSIS

<b>Client:</b> T. Harris Environmental 931 Commissioners Rd E St.100 London Ontario Canada N5Z3H9	<b>Report Date:</b> 6/14/2011 <b>Report No.:</b> 242527 <b>Project:</b> Victoria PS Reassessment <b>Project No.:</b> 11-1707-48
---	--

### BULK SAMPLE ANALYSIS SUMMARY

<b>Lab No.:</b> 4327399	<b>Description / Location:</b> Tan Ceiling Tile		
<b>Client No.:</b> ACT-F-02	Corridor (Location 1.C01)		
<u>% Asbestos</u>	<u>Type</u>	<u>% Non-Asbestos Fibrous Material</u>	<u>Type</u>
None Detected	None Detected	35	Cellulose
		20	Fibrous Glass

<b>Lab No.:</b> 4327400	<b>Description / Location:</b> Tan Ceiling Tile		
<b>Client No.:</b> ACT-F-03	Corridor (Location 1.C01)		
<u>% Asbestos</u>	<u>Type</u>	<u>% Non-Asbestos Fibrous Material</u>	<u>Type</u>
None Detected	None Detected	35	Cellulose
		20	Fibrous Glass

<b>Lab No.:</b> 4327401	<b>Description / Location:</b> Tan Ceiling Tile		
<b>Client No.:</b> ACT-G-01	C.L.N. (Location 1.20)		
<u>% Asbestos</u>	<u>Type</u>	<u>% Non-Asbestos Fibrous Material</u>	<u>Type</u>
None Detected	None Detected	35	Cellulose
		20	Fibrous Glass

<b>Lab No.:</b> 4327402	<b>Description / Location:</b> Tan Ceiling Tile		
<b>Client No.:</b> ACT-G-02	C.L.N. (Location 1.20)		
<u>% Asbestos</u>	<u>Type</u>	<u>% Non-Asbestos Fibrous Material</u>	<u>Type</u>
None Detected	None Detected	35	Cellulose
		20	Fibrous Glass

**Accreditations:**      **NIST-NVLAP No. 101165-0**      **NY-DOH No. 11021**      **AIHA-LAP, LLC No. 100188**  
*This confidential report relates only to those item(s) tested and does not represent an endorsement by NIST-NVLAP, AIHA or any agency of the U.S. government  
 This report shall not be reproduced except in full, without written approval of the laboratory.*

**Analytical Method**      EPA 600/R-93/116

**Comments:** (PC) Indicates Stratified Point Count Method performed. Method not performed unless stated. Quantification at <0.25% by volume is possible with this method. (PC-Trace) represents this limit of quantitation. (PC-Trace) means that asbestos was detected but is not quantifiable under the Point Counting regimen. Analysis includes all distinct separable layers in accordance with EPA 600 Method. If not reported or otherwise noted, layer is either not present or the client has specifically requested that it not be analyzed. Small asbestos fibers may be missed by PLM due to resolution limitations of the optical microscope. Therefore, negative PLM results cannot be guaranteed. Electron Microscopy can be used as a confirming technique. Regulatory Limit is based upon the sample matrix.

**Analysis Performed By:**      E. Smith

**Date:**      6/14/2011

## CERTIFICATE OF ANALYSIS

<b>Client:</b>	T. Harris Environmental 931 Commissioners Rd E St.100 London Ontario Canada N5Z3H9	<b>Report Date:</b>	6/14/2011
		<b>Report No.:</b>	242527
		<b>Project:</b>	Victoria PS Reassessment
		<b>Project No.:</b>	11-1707-48

### BULK SAMPLE ANALYSIS SUMMARY

<b>Lab No.:</b>	4327403	<b>Description / Location:</b>	Tan Ceiling Tile	
<b>Client No.:</b>	ACT-G-03		C.L.N. (Location 1.20)	
<u>% Asbestos</u>	<u>Type</u>	<u>% Non-Asbestos Fibrous Material</u>	<u>Type</u>	<u>% Non-Fibrous Material</u>
None Detected	None Detected	35	Cellulose	45
		20	Fibrous Glass	

<b>Lab No.:</b>	4327404	<b>Description / Location:</b>	Tan Fibrous	
<b>Client No.:</b>	Cellulose-01		Girls Washroom (Location 1.31)	
<u>% Asbestos</u>	<u>Type</u>	<u>% Non-Asbestos Fibrous Material</u>	<u>Type</u>	<u>% Non-Fibrous Material</u>
PC 1.2	Chrysotile	PC 98.8	Cellulose	None Detected

<b>Lab No.:</b>	4327404	<b>Description / Location:</b>	Tan Wrap	<b>Layer No.:</b> 2
<b>Client No.:</b>	Cellulose-01		Girls Washroom (Location 1.31)	
<u>% Asbestos</u>	<u>Type</u>	<u>% Non-Asbestos Fibrous Material</u>	<u>Type</u>	<u>% Non-Fibrous Material</u>
None Detected	None Detected	100	Cellulose	None Detected

<b>Lab No.:</b>	4327405	<b>Description / Location:</b>	Sample Not Analyzed	
<b>Client No.:</b>	Cellulose-02			
<u>% Asbestos</u>	<u>Type</u>	<u>% Non-Asbestos Fibrous Material</u>	<u>Type</u>	<u>% Non-Fibrous Material</u>
Sample Not Analyzed		Sample Not Analyzed		

<b>Accreditations:</b>	<b>NIST-NVLAP No. 101165-0</b>	<b>NY-DOH No. 11021</b>	<b>AIHA-LAP, LLC No. 100188</b>
	<i>This confidential report relates only to those item(s) tested and does not represent an endorsement by NIST-NVLAP, AIHA or any agency of the U.S. government</i>		
	<i>This report shall not be reproduced except in full, without written approval of the laboratory.</i>		

<b>Analytical Method</b>	EPA 600/R-93/116
--------------------------	------------------

**Comments:** (PC) Indicates Stratified Point Count Method performed. Method not performed unless stated. Quantification at <0.25% by volume is possible with this method. (PC-Trace) represents this limit of quantitation. (PC-Trace) means that asbestos was detected but is not quantifiable under the Point Counting regimen. Analysis includes all distinct separable layers in accordance with EPA 600 Method. If not reported or otherwise noted, layer is either not present or the client has specifically requested that it not be analyzed. Small asbestos fibers may be missed by PLM due to resolution limitations of the optical microscope. Therefore, negative PLM results cannot be guaranteed. Electron Microscopy can be used as a confirming technique. Regulatory Limit is based upon the sample matrix.

**Analysis Performed By:**           E. Smith          

**Date:**           6/14/2011

---

**CERTIFICATE OF ANALYSIS**

---

<b>Client:</b>	T. Harris Environmental	<b>Report Date:</b>	6/14/2011
	931 Commissioners Rd E St.100	<b>Report No.:</b>	242527
	London Ontario Canada N5Z3H9	<b>Project:</b>	Victoria PS Reassessment
		<b>Project No.:</b>	11-1707-48

---

**BULK SAMPLE ANALYSIS SUMMARY**

---

<b>Lab No.:</b>	4327406	<b>Description / Location:</b>	Tan Wrap	
<b>Client No.:</b>	Cellulose-02		Girls Washroom (Location1.31)	
<u>% Asbestos</u>	<u>Type</u>	<u>% Non-Asbestos Fibrous Material</u>	<u>Type</u>	<u>% Non-Fibrous Material</u>
None Detected	None Detected	100	Cellulose	None Detected

---

<b>Lab No.:</b>	4327407	<b>Description / Location:</b>	Tan Wrap	
<b>Client No.:</b>	DuctConnector-02		JanitorsRoom-UpperFanRoom(Location2.10)	
<u>% Asbestos</u>	<u>Type</u>	<u>% Non-Asbestos Fibrous Material</u>	<u>Type</u>	<u>% Non-Fibrous Material</u>
None Detected	None Detected	98	Cellulose	1
		1	Fibrous Glass	

---

<b>Lab No.:</b>	4327408	<b>Description / Location:</b>	Tan Wrap	
<b>Client No.:</b>	DuctConnector-03		JanitorsRoom-UpperFanRoom(Location2.10)	
<u>% Asbestos</u>	<u>Type</u>	<u>% Non-Asbestos Fibrous Material</u>	<u>Type</u>	<u>% Non-Fibrous Material</u>
None Detected	None Detected	98	Cellulose	1
		1	Fibrous Glass	

---

---

**Accreditations:** **NIST-NVLAP No. 101165-0** **NY-DOH No. 11021** **AIHA-LAP, LLC No. 100188**

*This confidential report relates only to those item(s) tested and does not represent an endorsement by NIST-NVLAP, AIHA or any agency of the U.S. government  
This report shall not be reproduced except in full, without written approval of the laboratory.*

---

**Analytical Method** EPA 600/R-93/116

**Comments:** (PC) Indicates Stratified Point Count Method performed. Method not performed unless stated. Quantification at <0.25% by volume is possible with this method. (PC-Trace) represents this limit of quantitation. (PC-Trace) means that asbestos was detected but is not quantifiable under the Point Counting regimen. Analysis includes all distinct separable layers in accordance with EPA 600 Method. If not reported or otherwise noted, layer is either not present or the client has specifically requested that it not be analyzed. Small asbestos fibers may be missed by PLM due to resolution limitations of the optical microscope. Therefore, negative PLM results cannot be guaranteed. Electron Microscopy can be used as a confirming technique. Regulatory Limit is based upon the sample matrix.

---

**Analysis Performed By:** E. Smith**Date:** 6/14/2011





---

---

**APPENDIX II**  
**ROOM BY ROOM SHEETS**

---

---

# Assessment Report

(sorted by asset ID)

Victoria PS

Registered user:T. Harris Environmental

Design	Description	Quantity	Cond.	Sample	Asbestos type	Access.	Action
--------	-------------	----------	-------	--------	---------------	---------	--------

Building Number :44 Survey date: Building name or address P Victoria Public School

Level : 1 - Main Floor Asbestos present : Yes  
Room : 1.01 - Classroom

Ceiling	Encapsulated Ceiling	766.0	sq.ft	Good	SAS 4	Chrysotile 3.00%	1	N
Floor	1' x 1' Floor Tile	766.0	sq.ft	Good			1	N

Comments: Encapsulated Ceiling  
Suspect 1' x 1' Vinyl Floor Tile

Level : 1 - Main Floor Asbestos present : Yes  
Room : 1.02 - Classroom

Ceiling	Encapsulated Ceiling	763.0	sq.ft	Good	SAS 4	Chrysotile 3.00%	1	N
Floor	1' x 1' Floor Tile	763.0	sq.ft	Good			1	N

Comments: Encapsulated Ceiling  
Suspect 1' x 1' Vinyl Floor Tile

Level : 1 - Main Floor Asbestos present : Yes  
Room : 1.03 - Vestibule

Ceiling	Encapsulated Ceiling	276.0	sq.ft	Good	SAS 4	Chrysotile 3.00%	1	N
---------	----------------------	-------	-------	------	-------	------------------	---	---

Comments: Encapsulated Ceiling

Level : 1 - Main Floor Asbestos present : Yes  
Room : 1.04 - Classroom

Ceiling	Encapsulated Ceiling	757.0	sq.ft	Good	SAS 4	Chrysotile 3.00%	1	N
Floor	1' x 1' Floor Tile	757.0	sq.ft	Good			1	N

Comments: Encapsulated Ceiling  
Suspect 1' x 1' Vinyl Floor Tile

Level : 1 - Main Floor Asbestos present : Yes  
Room : 1.05 - Classroom

Ceiling	Encapsulated Ceiling	765.0	sq.ft	Good	SAS 4	Chrysotile 3.00%	1	N
Floor	1' x 1' Floor Tile	765.0	sq.ft	Good			1	N

# Assessment Report

(sorted by asset ID)

Victoria PS

Registered user:T. Harris Environmental

Design	Description	Quantity	Cond.	Sample	Asbestos type	Access.	Action
--------	-------------	----------	-------	--------	---------------	---------	--------

**Comments:** Encapsulated Ceiling  
Suspect 1' x 1' Vinyl Floor Tile

<b>Level :</b> 1 - Main Floor	<b>Asbestos present :</b> Yes
<b>Room :</b> 1.06 - Classroom	

Ceiling	Encapsulated Ceiling	764.0	sq.ft	Good	SAS 4	Chrysotile 3.00%	1	N
Floor	1' x 1' Floor Tile	764.0	sq.ft	Good			1	N

**Comments:** Encapsulated Ceiling  
Suspect 1' x 1' Vinyl Floor Tile

<b>Level :</b> 1 - Main Floor	<b>Asbestos present :</b> Yes
<b>Room :</b> 1.08 - Vestibule	

Ceiling	Encapsulated Ceiling	502.0	sq.ft	Good		Chrysotile 3.00%	1	N
---------	----------------------	-------	-------	------	--	------------------	---	---

**Comments:** Encapsulated Ceiling

<b>Level :</b> 1 - Main Floor	<b>Asbestos present :</b> Yes
<b>Room :</b> 1.09 - Classroom	

Ceiling	Encapsulated Ceiling	849.0	sq.ft	Good	SAS 4	Chrysotile 0.25%	1	N
Floor	1' x 1' Floor Tile	849.0	sq.ft	Good			1	N

**Comments:** Encapsulated Ceiling  
Suspect 1' x 1' Vinyl Floor Tile

<b>Level :</b> 1 - Main Floor	<b>Asbestos present :</b> Yes
<b>Room :</b> 1.10 - Administration	

Ceiling Tiles	2' x 4' Acoustic Ceiling Tiles	518.0	sq. ft	Good	ACT-A	Chrysotile 2.80%		
---------------	--------------------------------	-------	--------	------	-------	------------------	--	--

**Comments:** 2' x 4' Acoustic Ceiling Tiles  
2' x 4' Acoustic Ceiling Tiles

<b>Level :</b> 1 - Main Floor	<b>Asbestos present :</b> Yes
<b>Room :</b> 1.11 - Health Room	

Ceiling Tiles	2' x 4' Acoustic Ceiling Tiles	208.0	sq. ft		ACT-A	Chrysotile 2.80%		
Floor	1' x 1' Floor Tile	208.0	sq.ft	suspect			1	N

# Assessment Report

(sorted by asset ID)

Victoria PS

Registered user:T. Harris Environmental

Design	Description	Quantity	Cond.	Sample	Asbestos type	Access.	Action
Lights	Heat Shield	1.0	Removed	1 (SACM 7)	Chrysotile 99.00%	1	Y
<p><b>Comments:</b> 2' x 4' Acoustic Ceiling Tiles Suspect 1' x 1' Vinyl floor tile</p>							
<p><b>Level :</b> 1 - Main Floor</p>				<p><b>Asbestos present :</b> Yes</p>			
<p><b>Room :</b> 1.12 - Staff Room</p>							
Ceiling Tiles		336.0 sq. ft		ACT-A	Chrysotile 2.80%		
<p><b>Comments:</b> 2' x 4' Acoustic Ceiling Tiles</p>							
<p><b>Level :</b> 1 - Main Floor</p>				<p><b>Asbestos present :</b> Yes</p>			
<p><b>Room :</b> 1.13 - Vice Principal</p>							
Ceiling Tiles	2' x 4' Acoustic Ceiling Tiles	138.0 sq. ft		ACT-A	Chrysotile 2.80%		
<p><b>Comments:</b> 2' x 4' Acoustic Ceiling Tiles</p>							
<p><b>Level :</b> 1 - Main Floor</p>				<p><b>Asbestos present :</b> Yes</p>			
<p><b>Room :</b> 1.15 - Early Years</p>							
Ceiling Tiles	2' x 4' Acoustic Ceiling Tiles	1,046.0 sq. ft		ACT-A	Chrysotile 2.80%		
Floor	1' x 1' Floor Tile	500.0 sq.ft	Good			1	N
Lights	Heat Shield	2.0	Removed	SAS 1	Chrysotile 99.00%	1	Y
<p><b>Comments:</b> 2' x 4' Acoustic Ceiling Tiles Suspect 1' x 1' vinyl floor tile.</p>							
<p><b>Level :</b> 1 - Main Floor</p>				<p><b>Asbestos present :</b> Yes</p>			
<p><b>Room :</b> 1.18 - Storage Room</p>							
Ceiling Tiles	2' x 4' Acoustic Ceiling Tiles	78.0 sq. ft		ACT-A	Chrysotile 2.80%		
Floor	1' x 1' Floor Tile	78.0 sq.ft	suspect			1	N
<p><b>Comments:</b> 2' x 4' Acoustic Ceiling Tiles Suspect 1' x 1' Vinyl Floor Tile</p>							
<p><b>Level :</b> 1 - Main Floor</p>				<p><b>Asbestos present :</b> Yes</p>			
<p><b>Room :</b> 1.19 - Office</p>							

# Assessment Report

(sorted by asset ID)

Victoria PS

Registered user:T. Harris Environmental

Design	Description	Quantity	Cond.	Sample	Asbestos type	Access.	Action
Ceiling Tiles	2' x 4' Acoustic Ceiling Tiles	96.0 sq. ft		ACT-A	Chrysotile 2.80%		
Floor	1' x 1' Floor Tile	96.0 sq.ft	suspect			1	N

**Comments:** 2' x 4' Acoustic Ceiling Tiles  
Suspect 1' x 1' Vinyl Floor Tile

**Level :** 1 - Main Floor

**Asbestos present :** Yes

**Room :** 1.20 - C.L.N.

Ceiling Tiles	2' x 4' Acoustic Ceiling Tiles			ACT-A	Chrysotile 2.80%		
Floor	1' x 1' Floor Tile	838.0 sq.ft	suspect			1	N

**Comments:** 2' x 4' Acoustic Ceiling Tiles  
Suspect 1' x 1' Vinyl Floor Tile

**Level :** 1 - Main Floor

**Asbestos present :** Suspect

**Room :** 1.21 - Early Years

Floor	1' x 1' Floor Tile	350.0 sq.ft	suspect			1	N
-------	--------------------	-------------	---------	--	--	---	---

**Comments:** 1' x 1' Floor Tile  
Suspect 1' x 1' Vinyl Floor Tile

**Level :** 1 - Main Floor

**Asbestos present :** Yes

**Room :** 1.23 - Classroom

Ceiling Tiles	2' x 4' Acoustic Ceiling Tiles	783.0 sq. ft		ACT-A	Chrysotile 2.80%		
Floor	1' x 1' Floor Tile	783.0 sq.ft	suspect			1	N

**Comments:** 2' x 4' Acoustic Ceiling Tiles  
Suspect 1' x 1' Vinyl Floor Tile

**Level :** 1 - Main Floor

**Asbestos present :** Suspect

**Room :** 1.24 - Boys' Washroom

Floor	1' x 1' Floor Tile	92.0 sq.ft	suspect			1	N
-------	--------------------	------------	---------	--	--	---	---

**Comments:** 1' x 1' Floor Tile  
Suspect 1' x 1' Vinyl Floor Tile

# Assessment Report

(sorted by asset ID)

Victoria PS

Registered user:T. Harris Environmental

Design	Description	Quantity	Cond.	Sample	Asbestos type	Access.	Action
--------	-------------	----------	-------	--------	---------------	---------	--------

**Level :** 1 - Main Floor  
**Room :** 1.25 - Classroom

**Asbestos present :** Suspect

Floor	1' x 1' Floor Tile	805.0	sq.ft	suspect		1	N
-------	--------------------	-------	-------	---------	--	---	---

**Comments:** 1' x 1' Floor Tile  
Suspect 1' x 1' Vinyl Floor Tile

**Level :** 1 - Main Floor  
**Room :** 1.29 - Storage Room

**Asbestos present :** REMOVED

Pipe	Aircell insulation	80.0	lf	Removed		3	Y
------	--------------------	------	----	---------	--	---	---

**Comments:** Pipe Insulation  
Pipe insulation hidden in pipe chase. Very limited access.

**Level :** 1 - Main Floor  
**Room :** 1.30 - Gym

**Asbestos present :** Yes

Ceiling	Encapsulated Ceiling	2,819.0	sq.ft	Good	SAS 4	Chrysotile 3.00%	1	N
---------	----------------------	---------	-------	------	-------	------------------	---	---

**Comments:** Encapsulated Ceiling

**Level :** 1 - Main Floor  
**Room :** 1.31 - Girls Washroom

**Asbestos present :** Yes

Ceiling Tiles	2' x 4' Acoustic Ceiling Tiles	241.0			ACT-D-0	Chrysotile 3.30%		
Mechanical Insulation	Pipe Fitting Insulation	12.0		Good	FITTING	Chrysotile 40.00%		
Piping	Cellulose Pipe Insulation				CELLUL OSE-01	Chrysotile 1.20%		
Piping	Cellulose Pipe Insulation				CELLUL OSE-02	Chrysotile 1.20%		
Piping	Cellulose Pipe Insulatoin				CELLUL OSE-03	Chrysotile 1.20%		

**Comments:** Pipe and Pipe Fitting Insulation  
2' x 4' Acoustic Ceiling Tiles

**Level :** 1 - Main Floor  
**Room :** 1.33 - Storage Room

**Asbestos present :** Yes

Ceiling Tiles	2' x 4' Acoustic Ceiling Tiles	204.0	sq. ft		ACT-A	Chrysotile 2.80%		
---------------	--------------------------------	-------	--------	--	-------	------------------	--	--

# Assessment Report

(sorted by asset ID)

Victoria PS

Registered user:T. Harris Environmental

Design	Description	Quantity	Cond.	Sample	Asbestos type	Access.	Action
Floor	1' x 1' Floor Tile	204.0 sq.ft	suspect			1	N
Mechanical Insulation	Pipe Fitting Insulation	2.0	Removed			1	N

**Comments:** 2' x 4' Acoustic Ceiling Tiles  
Suspect 1' x 1' Vinyl Floor Tile

**Level :** 1 - Main Floor **Asbestos present :** Yes  
**Room :** 1.34 - C.L.N.

Ceiling Tiles	2' x 4' Acoustic Ceiling Tiles	1,192.0 sq. ft		ACT-A	Chrysotile 2.80%		
Floor	1' x 1' Floor Tile	500.0 sq.ft	suspect			1	N

**Comments:** 2' x 4' Acoustic Ceiling Tiles  
Suspect 1' x 1' Vinyl Floor Tile

**Level :** 1 - Main Floor **Asbestos present :** REMOVED  
**Room :** 1.36 - Maintenance

Mechanical Insulation	Pipe Fitting Insulation	15.0	Removed			1	N
-----------------------	-------------------------	------	---------	--	--	---	---

**Comments:** Elbow Fittings

**Level :** 1 - Main Floor **Asbestos present :** Yes  
**Room :** 1.38 - Girls Washroom

Ceiling Tiles	2' x 4' Acoustic Ceiling Tiles	548.0 sq. ft		ACT-A	Chrysotile 2.80%		
Mechanical Insulation	Transite Pipe	8.0 ft.		TRANSI TE			

**Comments:** 2' x 4' Acoustic Ceiling Tiles

**Level :** 1 - Main Floor **Asbestos present :** Yes  
**Room :** 1.39 - Custodian Office

Mechanical Insulation	Pipe Fitting Insulation	8.0	Good		Chrysotile 40.00%	1	N
-----------------------	-------------------------	-----	------	--	-------------------	---	---

**Comments:** Elbow Fittings

**Level :** 1 - Main Floor **Asbestos present :** REMOVED  
**Room :** 1.40 - Janitor Storage

Mechanical Insulation	Pipe Fitting Insulation	10.0	Removed			1	N
-----------------------	-------------------------	------	---------	--	--	---	---

# Assessment Report

(sorted by asset ID)

Victoria PS

Registered user:T. Harris Environmental

Design	Description	Quantity	Cond.	Sample	Asbestos type	Access.	Action
--------	-------------	----------	-------	--------	---------------	---------	--------

**Comments:** Elbow Fittings

**Level :** 1 - Main Floor

**Asbestos present :** Yes

**Room :** 1.42 - Electrical

Mechanical Insulation	Pipe Fitting Insulation	4.0		Good		1	N
-----------------------	-------------------------	-----	--	------	--	---	---

**Comments:** Elbow Fittings

**Level :** 1 - Main Floor

**Asbestos present :** Yes

**Room :** 1.43 - Boiler Room

Mechanical Insulation	Pipe Fitting Insulation	30.0		Good		1	N
-----------------------	-------------------------	------	--	------	--	---	---

**Comments:** Elbow Fittings

**Level :** 1 - Main Floor

**Asbestos present :** Yes

**Room :** 1.44 - Boys' Change Room

Ceiling Tiles	2' x 4' Acoustic Ceiling Tiles				ACT-A Chrysotile 2.80%		
---------------	--------------------------------	--	--	--	------------------------	--	--

**Comments:** 2' x 4' Acoustic Ceiling Tiles

**Level :** 1 - Main Floor

**Asbestos present :** Yes

**Room :** 1.48 - Classroom

Ceiling Tiles	2' x 4' Acoustic Ceiling Tiles				ACT-A Chrysotile 2.80%		
---------------	--------------------------------	--	--	--	------------------------	--	--

Floor	1' x 1' Floor Tile	898.0	sq.ft	suspect		1	N
-------	--------------------	-------	-------	---------	--	---	---

**Comments:** 2' x 4' Acoustic Ceiling Tiles  
Suspect 1' x 1' Vinyl Floor Tile

**Level :** 1 - Main Floor

**Asbestos present :** Yes

**Room :** 1.51 - Storage

Ceiling	Encapsulated Ceiling	100.0	sq. ft		SAS 4		
Floor	1' x 1' Floor Tile	100.0	sq. ft		SUSPEC		

**Comments:** Encapsulated Ceiling



# Assessment Report

(sorted by asset ID)

Victoria PS

Registered user:T. Harris Environmental

Design	Description	Quantity	Cond.	Sample	Asbestos type	Access.	Action
<b>Level : 1 - Main Floor</b>		<b>Asbestos present : Yes</b>					
<b>Room : 1.C01 - West Corridor</b>							
Ceiling	2x4 Tile - Pinhole and Fissure		Good	SAS 2	Chrysotile 10.00%	1	N
<b>Comments:</b> 2' x 4' Ceiling Tile							
<b>Level : 1 - Main Floor</b>		<b>Asbestos present : Yes</b>					
<b>Room : 1.C02 - North Central Corridor</b>							
Ceiling	2x4 Tile - Pinhole and Fissure		Good	SAS 2	Chrysotile 10.00%	1	N
Mechanical Insulation	Aircell Pipe Insulation	5.0 ft.	Good	AIRCEL L-01	Chrysotile 45.00%		
<b>Comments:</b> 2' x 4' Ceiling Tile							
<b>Level : 1 - Main Floor</b>		<b>Asbestos present : Yes</b>					
<b>Room : 1.C03 - North Corridor</b>							
Ceiling	2x4 Tile - Pinhole and Fissure		Good	SAS 2	Chrysotile 10.00%	1	N
<b>Comments:</b> 2' x 4' Ceiling Tile							
<b>Level : 1 - Main Floor</b>		<b>Asbestos present : Yes</b>					
<b>Room : 1.C04 - Northeast Corridor</b>							
Ceiling	2x4 Tile - Pinhole and Fissure		Good	SAS 2	Chrysotile 10.00%	1	N
<b>Comments:</b> 2' x 4' Ceiling Tile							
<b>Level : 1 - Main Floor</b>		<b>Asbestos present : Yes</b>					
<b>Room : 1.C05 - Southeast Corridor</b>							
Ceiling	2x4 Tile - Pinhole and Fissure		Good	12A-C	Chrysotile 10.00%	1	N
Mechanical Insulation	Pipe Fitting Insulation	23.0	Good	SAS 1	Chrysotile 40.00%	1	N
<b>Comments:</b> Varied Materials 2' x 4' Ceiling Tiles							

# Assessment Report

(sorted by asset ID)

Victoria PS

Registered user:T. Harris Environmental

Design	Description	Quantity	Cond.	Sample	Asbestos type	Access.	Action
--------	-------------	----------	-------	--------	---------------	---------	--------

**Level : 1 - Main Floor**

**Asbestos present : Yes**

**Room : 1.C06 - Southeast Corridor**

Ceiling Tiles	2' x 4' Acoustic Ceiling Tiles				ACT-A	Chrysotile 2.80%		
Mechanical Insulation	Pipe Fitting Insulation	10.0		Good	SAS 1	Chrysotile 40.00%		N

**Comments:** Varied Materials

**Level : 2 - Second Floor**

**Asbestos present : Yes**

**Room : 2.03 - Classroom**

Ceiling	Encapsulated Ceiling	878.0	sq.ft	Good	SAS 4	Chrysotile 3.00%	1	N
Floor	9" x 9" Vinyl Floor Tiles	878.0	sq.ft	suspect			1	N

**Comments:** Varied asbestos materials  
Suspect 9" x 9" Vinyl Floor Tile

**Level : 2 - Second Floor**

**Asbestos present : Yes**

**Room : 2.04 - Work Room**

Floor	9" x 9" Vinyl Floor Tiles	242.0	sq.ft	suspect			1	N
-------	---------------------------	-------	-------	---------	--	--	---	---

**Comments:** 9" x 9" vinyl floor tiles  
Suspect 9" x 9" Vinyl Floor Tile

**Level : 2 - Second Floor**

**Asbestos present : Yes**

**Room : 2.05 - Classroom**

Ceiling	Encapsulated Ceiling	873.0	sq.ft	Good	SAS 4	Chrysotile 3.00%	1	N
Floor	1' x 1' Floor Tile	873.0	sq.ft	suspect			1	N

**Comments:** Encapsulated Ceiling  
Suspect 1' x 1' Vinyl Floor Tile

**Level : 2 - Second Floor**

**Asbestos present : Yes**

**Room : 2.06 - Vestibule**

Ceiling	Encapsulated Ceiling	281.0	sq.ft	Good	SAS 4	Chrysotile 3.00%	1	N
---------	----------------------	-------	-------	------	-------	------------------	---	---

**Comments:** Encapsulated Ceiling

# Assessment Report

(sorted by asset ID)

Victoria PS

Registered user:T. Harris Environmental

Design	Description	Quantity	Cond.	Sample	Asbestos type	Access.	Action
--------	-------------	----------	-------	--------	---------------	---------	--------

**Level : 2 - Second Floor**  
**Room : 2.07 - Classroom**

**Asbestos present : Yes**

Ceiling	Encapsulated Ceiling	869.0	sq.ft	Good	SAS 4	Chrysotile 3.00%	1	N
Floor	9" x 9" Vinyl Floor Tiles	869.0	sq.ft	suspect			1	N

**Comments:** Varied asbestos materials  
Suspect 9" x 9" Vinyl Floor Tile

**Level : 2 - Second Floor**  
**Room : 2.08 - Classroom**

**Asbestos present : Yes**

Ceiling	Encapsulated Ceiling	872.0	sq.ft	Good	SAS 4	Chrysotile 3.00%	1	N
Floor	9" x 9" Vinyl Floor Tiles	872.0	sq.ft	Good	SAS 3	Chrysotile 6.50%	1	N

**Comments:** Varied asbestos materials  
Suspect 9" x 9" Vinyl Floor Tile

**Level : 2 - Second Floor**  
**Room : 2.09 - Classroom**

**Asbestos present : Yes**

Ceiling	Encapsulated Ceiling	871.0	sq.ft	Good	SAS 4	Chrysotile 3.00%	1	N
Floor	9" x 9" Vinyl Floor Tiles	871.0	sq.ft	Good	SAS 3	Chrysotile 6.50%	1	N

**Comments:** Varied asbestos materials  
Suspect 9" x 9" Vinyl Floor Tile

**Level : 2 - Second Floor**  
**Room : 2.12 - Classroom**

**Asbestos present : Yes**

Ceiling	Encapsulated Ceiling	901.0	sq.ft	Good	SAS 4	Chrysotile 3.00%	1	N
Floor	9" x 9" Vinyl Floor Tiles	901.0	sq.ft	Good	3 (SACM9)	Chrysotile 6.50%	1	N

**Comments:** Varied asbestos materials

**Level : 2 - Second Floor**  
**Room : 2.13 - Library**

**Asbestos present : Yes**

Ceiling Tiles	2' x 4' Acoustic Ceiling Tiles				ACT-A-0	Chrysotile 2.80%		
---------------	--------------------------------	--	--	--	---------	------------------	--	--

# Assessment Report

(sorted by asset ID)

Victoria PS

Registered user:T. Harris Environmental

Design	Description	Quantity	Cond.	Sample	Asbestos type	Access.	Action
--------	-------------	----------	-------	--------	---------------	---------	--------

Ceiling Tiles	2' x 4' Acoustic Ceiling Tiles			ACT-A-0	Chrysotile	2.80%	
---------------	--------------------------------	--	--	---------	------------	-------	--

**Comments:** 2' x 4' Acoustic Ceiling Tiles

**Level :** 2 - Second Floor

**Asbestos present :** Yes

**Room :** 2.14 - Library

Ceiling Tiles	2' x 4' Acoustic Ceiling Tiles	208.0	sq. ft	ACT-A	Chrysotile	2.80%	
---------------	--------------------------------	-------	--------	-------	------------	-------	--

**Comments:** 2' x 4' Acoustic Ceiling Tiles

**Level :** 2 - Second Floor

**Asbestos present :** Yes

**Room :** 2.15 - Library

Ceiling Tiles	2' x 4' Acoustic Ceiling Tiles			ACT-A	Chrysotile	2.80%	
---------------	--------------------------------	--	--	-------	------------	-------	--

**Comments:** 2' x 4' Acoustic Ceiling Tiles

**Level :** 2 - Second Floor

**Asbestos present :** Yes

**Room :** 2.16 - Library

Ceiling Tiles	2' x 4' Acoustic Ceiling Tiles			ACT-A	Chrysotile	2.80%	
---------------	--------------------------------	--	--	-------	------------	-------	--

**Comments:** 2' x 4' Acoustic Ceiling Tiles

**Level :** 2 - Second Floor

**Asbestos present :** Yes

**Room :** 2.17 - Library

Ceiling Tiles	2' x 4' Acoustic Ceiling Tiles	333.0	sq. ft	ACT-A	Chrysotile	2.80%	
---------------	--------------------------------	-------	--------	-------	------------	-------	--

**Comments:** 2' x 4' Acoustic Ceiling Tiles

**Level :** 2 - Second Floor

**Asbestos present :** Suspect

**Room :** 2.C01 - Southeast Corridor

Floor	1' x 1' Floor Tile			SUSPEC			
-------	--------------------	--	--	--------	--	--	--

**Comments:** 1' x 1' Vinyl Floor Tiles

**Level :** 2 - Second Floor

**Asbestos present :** Yes

**Room :** 2.C02 - Corridor

# Assessment Report

(sorted by asset ID)

Victoria PS

Registered user:T. Harris Environmental

Design	Description	Quantity	Cond.	Sample	Asbestos type	Access.	Action
--------	-------------	----------	-------	--------	---------------	---------	--------

Ceiling	Encapsulated Ceiling		Good	SAS 4	Chrysotile 3.00%	1	N
---------	----------------------	--	------	-------	------------------	---	---

**Comments:** Encapsulated Ceiling

**Level :** 2 - Second Floor

**Asbestos present :** Yes

**Room :** HALLWAY - Hallway

Ceiling	Encapsulated Ceiling		Good	SAS 4	Chrysotile 3.00%	1	N
---------	----------------------	--	------	-------	------------------	---	---

**Comments:** Encapsulated Ceiling